



SINCE 1994
STARBOARD
INNOVATION QUALITY



PADDLE BOARDING JUST BECAME THE PLANETS MOST POPULAR WATERSPORT.

The paddleboarding experience and getting people into nature is what we live for at Starboard. For the very best sports experience, we develop gear that will make each session better.

The first tip is the paddle, that little piece of equipment is perhaps the most important part, that's why we put so much work into developing our Enduro and Lima paddles. The Lima is also the most winning paddle in racing the last 3 years and Enduro is also used by the current World champ in the waves.

Inflatables are seeing good developments, and we have over the years pioneered the industry with the development of our welding technology for longevity, double chambers for stiffness and safety, and the Airline technology for an exceptional reflex and speed. What we did 8 years ago is now starting to become mainstream, and this year we would like to introduce the Wall, a dual thickness board, that gives you added stability and the opportunity to paddle a more narrow board.

On the hard board side the new Wedge and the new Pro's are rejuvenating wave riding while the Sprint/ Allstars just keeps on winning. A hot tip is that the 2021 Allstar is the most stable ever, utilizing the full extent of our dugout technology, that we pioneered 10 years ago.

After all these years we at Starboard have polluted the environment with our product production and travels. We know our impact and we act upon limiting our impact and through our planting of ½ million trees, to absorb ½ million ton CO₂ over 20 years. Our internal plastic tax (perhaps the worlds first) has allowed us to collect 87,000 kg beach plastic through our 'The Plastic Offset Program' project.

We are not only balancing our impact by going '10 x Climate Net Positive', we also introduced the concept of 'Climate Past Positive' making up for the whole of Starboards emissions, planting mangroves to sink down the equivalent estimated emissions from 1994.

For more information, please visit: <https://blue.star-board.com>

Thank you for making it all possible and thanks to Tiki for passing the torch to us.



Svein Rasmussen
Chief innovator

YOUR PADDLE, YOUR MOST IMPORTANT CHOICE !



LIMA BLADE

ENDURO BLADE

LIMA TUFKIN

CONSTRUCTIONS AND SIZES

PREPREG CARBON	TIKI TECH	PREPREG CARBON	UD CARBON	BALSA	TIKI TECH	KIDS	TIKI TECH	TUFKIN	PACKAGE MINI GO
NEW XXL XL L M S XS	TIKI BLUE NEW XL L M SONNI WAVE S M L	L M S	L NEW M NEW S XS	L M S	TIKI BLUE, TIKI GREY L M S SONNI SUN, WAVE M S	KIDS (based on Enduro XS)	TIKI TECH	NEW TUFKIN ADULT (based on Lima XL) KIDS (based on Enduro XS)	NEW PACKAGE MINI GO M

GRAPHIC OPTIONS

• Tiki Red Foil	• Tiki Blue • Sonni Wave	• Tiki Red Foil	• Tiki Silver Foil	• Balsa burn mark	• Tiki Blue • Tiki Grey • Sonni Sun • Sonni Wave	• Tiki Blue • Sonni Sun • Sonni Wave	• White	• White
-----------------	-----------------------------	-----------------	--------------------	-------------------	---	--	---------	---------

SHAFTS

Pregreg Carbon shafts	NEW Pregreg Hybrid Carbon shafts	Pregreg Carbon shafts	Filament Winding Carbon shafts	NEW Pregreg Hybrid Carbon shafts	NEW Pregreg Hybrid Carbon shafts	NEW Pregreg Hybrid Carbon shafts	Filament Winding Carbon shafts	Filament Winding Carbon shafts
• Oval S35/S40 • 29 mm S35/S40 • 27.5 mm S40 • 26 mm S40 NEW • 29 mm 2 pc Adjustable S35 NEW • 29 mm 3 pc Adjustable S35	Tiki Blue • 29 mm 2 pc Adjustable S35 • 29 mm 3 pc Adjustable S35 Sonni Wave • 26 mm 2 pc Adjustable S40	• 29 mm S40 NEW • 29 mm 2 pc Adjustable S35 NEW • 29 mm 3 pc Adjustable S35	• 29 mm S40 • 29 mm 2 pc Adjustable S35 • 29 mm 3 pc Adjustable S35	• 29 mm S40 • 29 mm 2 pc Adjustable S35	Tiki Blue and Tiki Grey • 29 mm 2 pc Adjustable S35 • 29 mm 3 pc Adjustable S35 Sonni Sun and Sonni Wave • 26 mm 2 pc Adjustable S40 • 26 mm 3 pc Adjustable S40	• Kids 2 pc Adjustable S40	Adult: NEW • 29 mm S40 • 29 mm 2 pc Adjustable S35 • 29 mm 3 pc Adjustable S35 Kids: NEW • Kids 2 pc Adjustable S40	NEW • 29 mm 4 pc Adjustable S35

OUR TECHNOLOGY CHOICES

- Flex and strength are tuned into each blade size and shape through the utilisation of Biaxial and Uni-Directional cloths.
- All 2021 blades are using plant based Bio resin, maintaining high performance with a lower impact on the environment.

PREPREG CARBON

THE TRUE WINNER

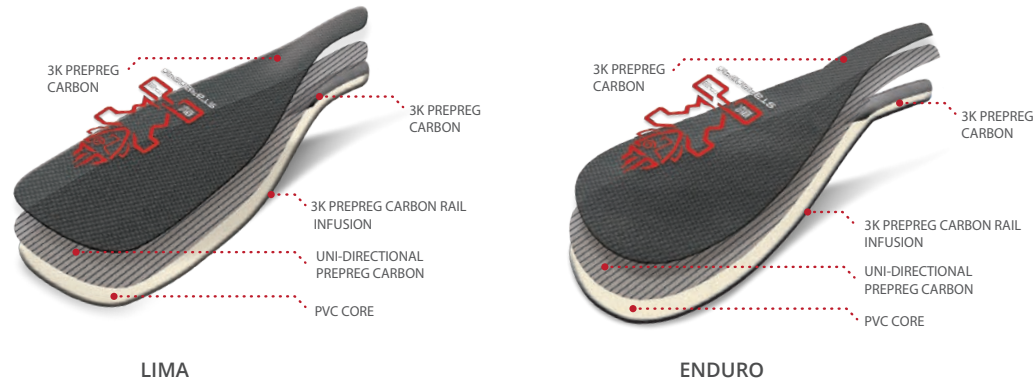

- Our top of the line super light, strong and responsive blade technology has taken another leap.
- Using full cover pre-impregnated top of the line 3K and Uni-directional carbon Fibers.
- Controlled resin uptake. The overall strength is increased with the high consistency pre-impregnation.
- Full 3K Prepreg Carbon infusion rail all the way up to the neck for increased durability and impact resistant.

FOIL CARBON

DESIGNED FOR TAKING IMPACT FROM FOILING

A durable and light performance blade with a highly protective Isosport top sheet, minimizing impact damage to the blade.

* Only aftermarket

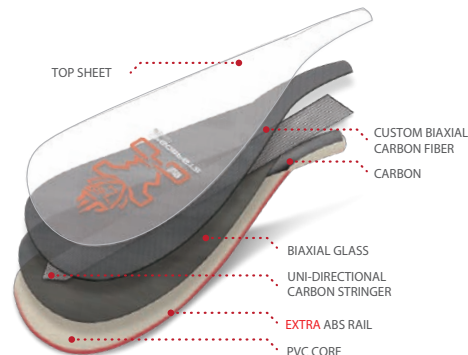

BALSA

HIGH PERFORMANCE AND LOW CARBON FOOTPRINT

- 100% long grain low-density balsa core for better strength and paddle sensation.
- Biaxial 45-degree glass fabric used to increase durability.
- Extended reinforcement on the blade neck for greater overall strength.
- Carbon UD flax pre-mold neck increased durability
- Carbon Filament rail infusion all the way up to the neck for increased durability and impact resistant
- Available only with Enduro shape, all sizes, paired with Hybrid Carbon Shafts.

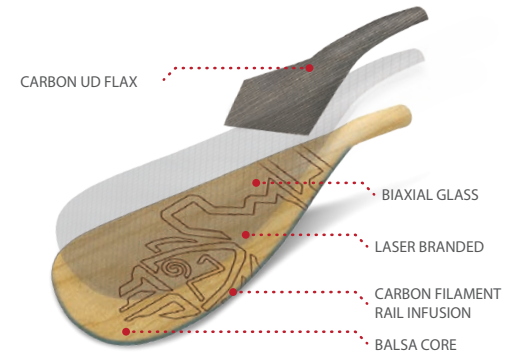

UD CARBON

AMAZING VALUE

- Full cover UD Carbon lamination to create extra low weight, maximize strength and high reflex characteristics.
- Carbon filament rail infusion for impressive impact strength.
- Light weight PVC Core
- Available in Enduro shape, all size, paired with Filament Winding Carbon shaft



TIKI TECH

THE BEST-SELLER

- Strong protective top sheet covering artwork and surface finish.
- UD Carbon stringer continues all the way from the neck to the top of the blade, enhancing the reflex characteristics and strength.
- Full Biax glass fiber Filament rail infusion all the way up to the neck for greater overall strength.
- Extended reinforcement on the blade neck for greater overall strength.
- All size Tiki Tech blades sold separately in Blue and Grey. Sonni Sun and Wave available in M and S.

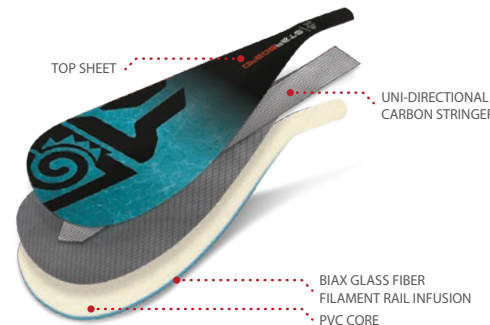

NEW

TUFSKIN

DURABLE PERFORMANCE

- Strong and extremely durable ABS foils based on the new Lima shape.
- Slim profile reduces weight 15g for improved efficiency.
- Perfect for whitewater paddling and schools due to extreme strength and high impact resistance.
- Great value due to strength and high quality shape.



OUR INFLATABLE BOARD, ONE STEP AHEAD



BEST SELLERS

iGO / MINIGO

P. 18-23

iGO: Different sizes and constructions for all rider types and expectations
MiniGO: Good thing, small package



BEST SELLERS

TOURING

P. 24-25

It's an explorer's favourite transportation. Ideal for short or long distances, flat or small chop, the Touring makes the journey possible!



ALL STAR

P. 26-29

Faster than most hard board



THE WALL

P. 30-31

Ultra stiff, ultra stable and super comfortable.



SURF / FOIL

P. 32-33

Surfing real waves and foiling the smallest bumps on inflatable boards has never been easier.



YOGA

P. 34-35

Life is balance. Tune into your board and body



RIVER

P. 36

White water calls. Rivers are the new frontier



TEAM

P.37

Make SUP and Windsurfing a family sport



SUPKIDS

P. 84-85

Small boards for small rippers



SUP WINDSURFING

P. 86-87

It's time to hold the wind in your arms



WING FOIL/ WING 4in1

P. 90-91

Standing on air and flying over water.

DOUBLE CHAMBER

SAFER • STIFFER • LIGHTER

DROP STITCH
EXTRA LIGHT & STIFF

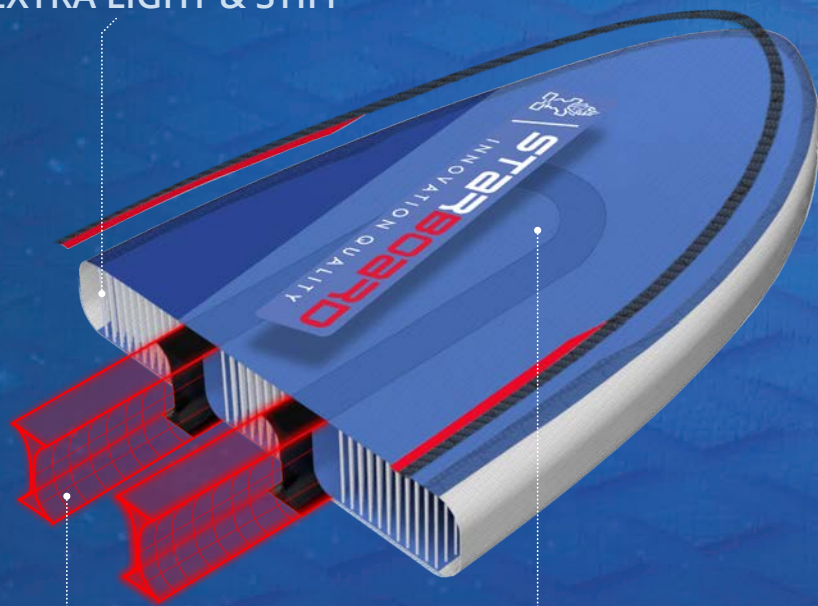

DOUBLE I-BEAM STRINGER
ULTRA STIFF

ROUNDED
SECOND
CHAMBER

SAFETY FIRST

The chamber offers up to 43 liters of safety floatation, with 21 liters even in the smallest boards that require only 10 PSI. Starboard pioneered Double Chamber tech in the 2013 Ocean Rescue board. Future Coast Guard regulations will possibly request this safety arrangement for inflatable board use in open waters.



ULTRA STIFF

The innovative chamber doubles the sidewalls and acts like rollable I-BEAMS. Starting just behind the standing area and continuing towards the front, the chamber is placed in the most critical area for flex and reduces deflection by 1.8 cm.

The feeling of paddling with the stiff Double I-BEAM stringer is getting very similar to a hard board, propelling inflatable technology one step closer to a "hard board" feel. A must have for riders over 85 kg.

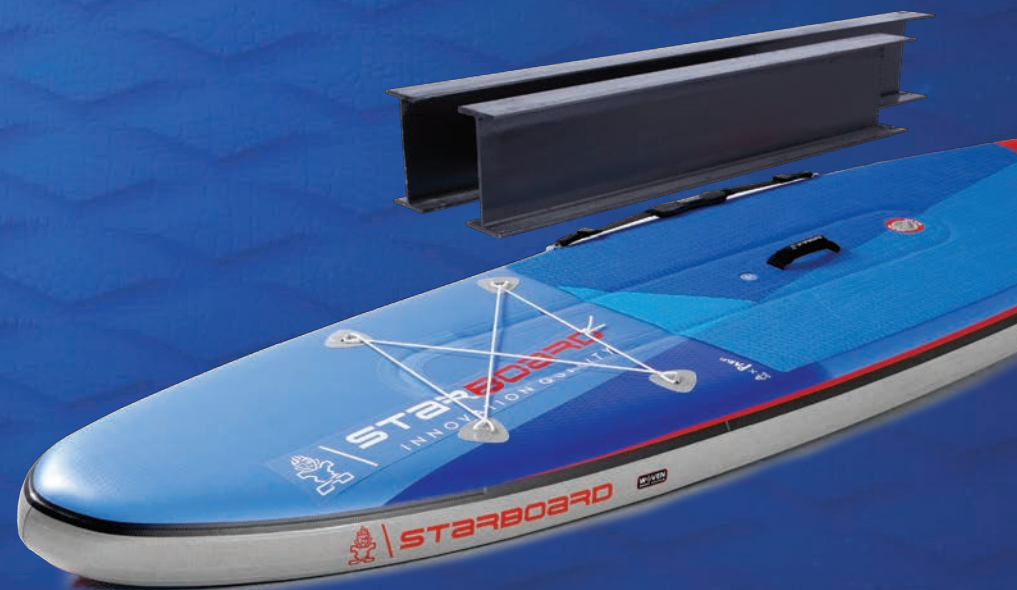

JUST ANOTHER STARBOARD INNOVATION FROM 2014

DELUXE THE MOST ADVANCED BUILD METHOD

- Woven dropstitch
- Extra stiff
- Welded
- Fusion
- Galvanized rails

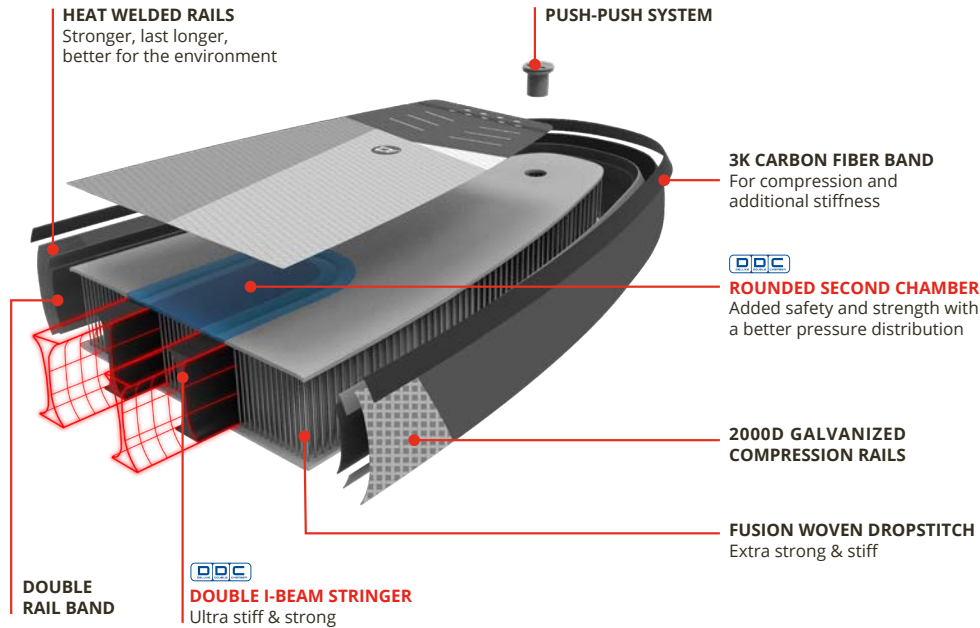
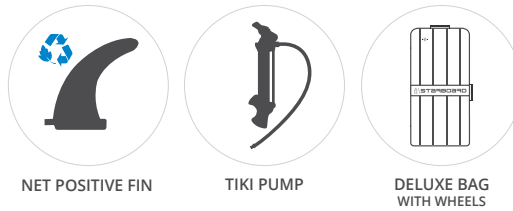

DELUXE DOUBLE CHAMBER

The welded technology adds durability to the board. Top and bottom layers are fused in a single, glueless process. The middle chamber further enhances stiffness and introduces a safety chamber. Galvanized 2000 D rails increases strength together with the 3K compression bands. The ultra strong fin box is the top of the range in durability and function. To finish it all off, we offer the Tiki pump with and extra strong backpack bag with roller wheels and carry straps, made from 18-23 recycled plastic bottles.

DELUXE SINGLE CHAMBER

The new woven dropstitch make the DELUXE SINGLE CHAMBER a solid winner at a lightweight. The Galvanized 2000 D rails set the DELUXE SINGLE CHAMBER further apart together with the breakthrough welded rail technology. Single fin option boards come with an ultra strong box and toolless fin. To finish it all off, we introduce the new Tiki pump.



ZEN EXCLUSIVE VALUE OFFERING

- Exclusive linear dropstitch
- Welded
- Extra rigid
- 2000 Denier stiffening side rails
- Extra safe
- High value

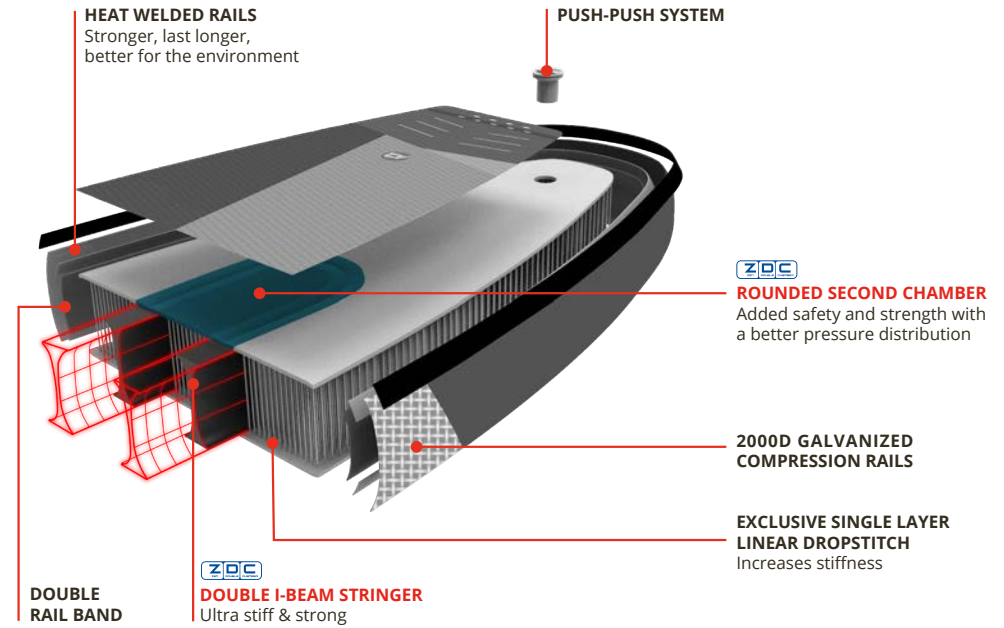
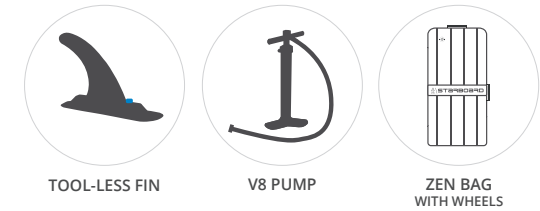

ZEN DOUBLE CHAMBER

The innovative Double Chamber is now available with the Zen boards resulting in a combination of the best from both worlds. Our leanest, lightest, value-oriented inflatable board with single layer linear dropstitch, has been upgraded with a second chamber and now also offers the extra stiffness and strength of the added second chamber. And together with the galvanized 2000D rails, the Zen Double Chamber boards have greater strength and stiffness. Designed with only the core essential accessories, the new Zen Double Chamber is the new winner in price point offering.



ZEN SINGLE CHAMBER

Our leanest, lightest, value-oriented inflatable board – with the best core essentials. Built with single layer LINEAR knitted dropstitch and heat welded rails, making it even stronger and stiffer than before. The single layer LINEAR knitted dropstitch was developed by Starboard in close cooperation with its supplier and is for Starboard use ONLY. The tool-less fin system is quick and easy to set up, now with a long and strong finbox.

EXCLUSIVE SINGLE LAYER



- MORE RESPONSIVE
- STIFFER
- LIGHTER

LINEAR
DROPSTITCH

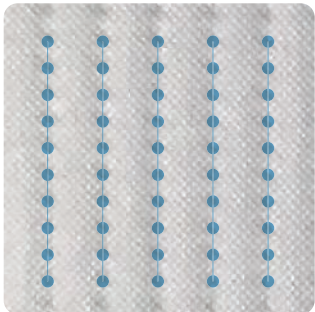

CROSS
DROPSTITCH

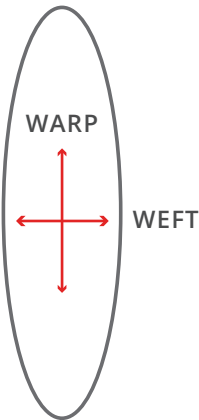
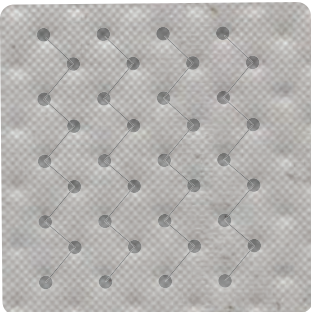

The vertical component of the dropstitch that joins deck and bottom together (space yarns) are distributed along the length of the board in a straight line. This maximizes the strength and rigidity of the board, providing a smoother paddle sensation and allowing to accelerate faster with less effort.



STRONGER, STIFFER, LIGHTER
AND MORE RESPONSIVE

After 5 years of research and development, we introduce the next evolution of inflatable board technology.

LESS YARNS = LIGHTER + LESS STRETCH = STIFFER

WOVEN TECHNOLOGY
Woven fabric weighs less because it uses less material – and because it only stretches diagonally, it holds more tension. What does this mean for you? A stiffer board.

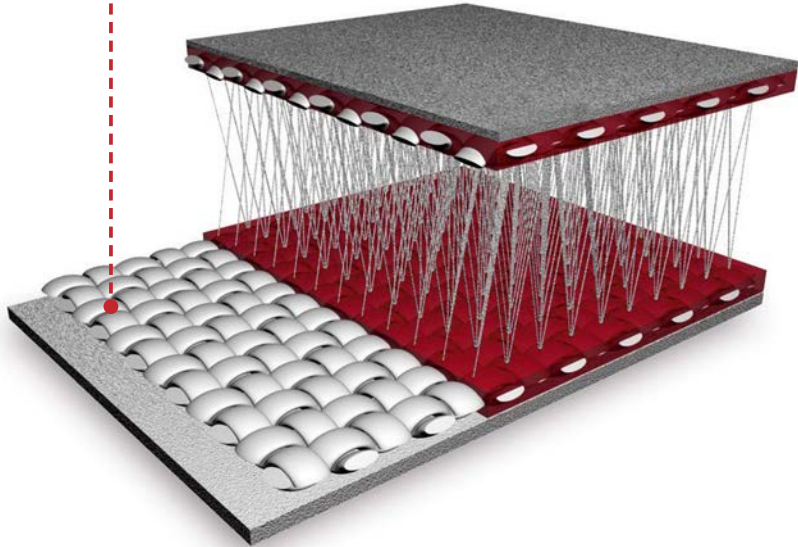

YARN REDUCTION LOWERS ENVIRONMENTAL IMPACT OF THE BOARD BY 10%



HEATED & BONDED FOR LIFE

MECHANICAL BOND
STRENGTH + DURABILITY

Glue is never forever.
Starboard's new welding technique turns two into one – using heat to bond two separate pieces of PVC into a single solid unit. Heat-welded PVC creates a mechanical bond that's stronger, lasts longer – and is better for the environment.

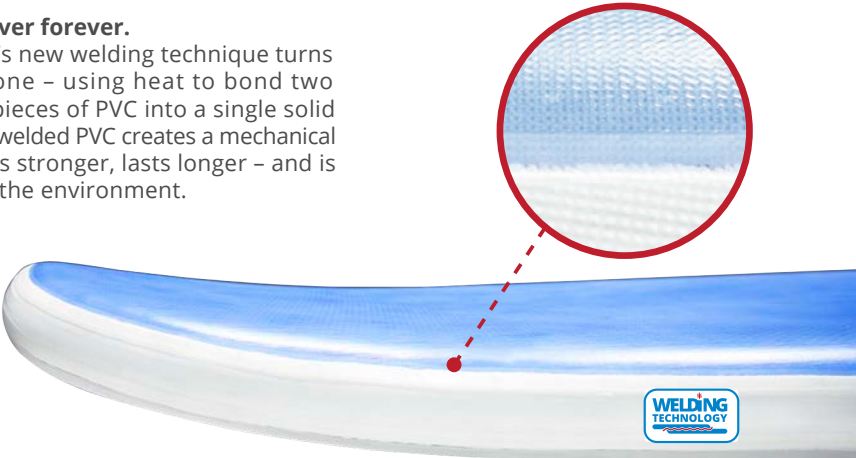

MECHANICAL BOND

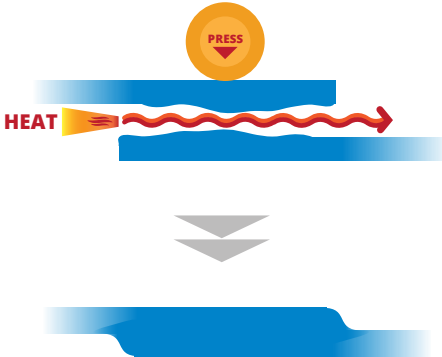

INFLATABLE

iGO <div>BEST SELLERS</div>						
	<div>NEW</div> 12'0" x 33"	<div>NEW</div> 11'2" x 31+"	<div>NEW</div> 10'8" x 33"	<div>NEW</div> 10'8" x 33" Mini GO	<div>NEW</div> 10'4" x 32"	<div>NEW</div> 10'0" x 34"
Thickness:	6"	DDC, DSC, ZDC: 6" ZSC: 5.5" Tikhine: 4.75"	DDC, DSC, ZDC: 6" ZSC: 5.5"	DSC: 6" ZSC: 5.5"	6"	4.75"
Tail Width:	18.1"	21"	20.1"	20.1"	19"	20.3"
Volume:	365 L	DDC, DSC, ZDC: 342 L ZSC: 319 L Tikhine: 274 L	DDC, DSC, ZDC: 331 L ZSC: 309 L	DSC: 331 L ZSC: 309 L	313 L	225 L
Rider Weight:	55-120 kg	45-100 kg	45-120 kg	45-120 kg	45-105 kg	45-90 kg
Fin Set Up:	Single	Single Tikhine: Thruster	Single	Single	Single	Thruster
Fins:	DDC: 9" DSC: 8"	DDC: 9" DSC: 8" ZDC, ZSC: Zen fin Tikhine: 3 Fixed	DDC: 9" DSC: 8" ZDC, ZSC: Zen fin	DSC: 8" ZSC: Zen fin	8"	3 Fixed

TEAM			
	18'6" x 60" STARSHIP ALL WATER	16'0" x 32" TANDEM	15'0" x 55" STARSHIP FAMILY
	8"	6"	8"
	34.3"	16.9"	28.1"
	1250 L	475 L	999 L
	900 kg	200 kg	450 kg
	SUP: Single WS: 5 Fins	SUP: Single WS: 3 Fins	SUP: Single WS: 5 Fins
	Center: 9" Side: Drake shallow 220	Center: 9" Side: Drake shallow 220	Center: 9" Side: Drake shallow 220

SUP WINDSURFING		
	<div>NEW</div> 11'2" x 31+" iGO	<div>NEW</div> 10'8" x 33" iGO
	6"	6"
	21"	20.1"
	342 L	331 L
	45-100 kg	45-120 kg
	SUP: Single WS: 2 Fins	SUP: Single WS: 2 Fins
	Back : 8" Removable center fins Drake shallow 220	Back : 8" Removable center fins Drake shallow 220

WING FOIL		4in1
	<div>NEW</div> 5'8" x 27" WINGBOARD	<div>NEW</div> 6'8" x 29" 7'0" x 31" WINGBOARD
	4.75"	4.75"
	21.6"	21.6"/21.6"
	118 L	152 L/174L
	45-80 kg	50-95 kg/ 55-105 kg
	Top plate foil	Top plate foil
		SUP: Single WS: 2 Fins

TOURING <div>BEST SELLERS</div>					
	<div>NEW</div> 14'0" x 32" TOURING L	<div>NEW</div> 14'0" x 30"	<div>NEW</div> 14'0" x 28" TOURING S	<div>NEW</div> 12'6" x 30"	<div>NEW</div> 12'6" x 28" TOURING S
Thickness:	6"	6"	6"	6" Tikhine: 4.75"	6"
Tail Width:	17.9"	16.6"	17.6"	19.3"	17.4"
Volume:	409 L	389 L	345 L	355 L Tikhine: 281 L	318 L
Rider Weight:	70-135 kg	60-120 kg	55-110 kg	55-110 kg	50-90 kg
Fin Set Up:	Single	Single	Single	Single	Single
Fins:	Zen fin	Dol-fin 22	Dol-fin 22	DDC, DSC, Tikhine: Dol-fin 22 ZDC, ZSC: Zen fin	Dol-fin 22

AIRLINE		
	<div>NEW</div> 14'0" x 28" ALL STAR DOWNWIND/ ALL STAR	<div>NEW</div> 14'0" x 26" 14'0" x 24.5"
	6"	6"
	17.9"	13.9", 14.6"
	367 L	323 L, 310 L
	60-115 kg	60-105 kg, 50-90 kg
	Single	Single
	Race 23"	Race 23"

THE WALL	
	<div>NEW</div> 14'0" x 30" 14'0" x 28"
	4.75"+2"
	16.7"/ 17.6"
	324 L/ 302 L
	60-115 kg/ 55-110 kg
	Single
	Dol-fin 22



SURF		
	<div>NEW</div> 9'5" x 32" SURF	<div>NEW</div> 6'8" x 27.5" HYPER FOIL
Thickness:	4.75"	4.75"
Tail Width:	17.8"	23.9"
Volume:	218 L	156 L
Rider Weight:	40-105 kg	60-105 kg
Fin Set Up:	Thruster	Top Plate Foil
Fins:	Center 8" Side 4.5" Balsa Core	

RIVER		
	11'0" x 34"	10'11" x 31"
	6"	6"
	21.8"	20"
	356 L	323 L
	60-115 kg	50-95 kg
	Thruster	Thruster
	Center Track&Slide fin Side 2.6" Glue on	Center Track&Slide fin Side 2.6" Glue on

YOGA	
	<div>NEW</div> 10'0" x 34" YOGA
	6"
	21.5"
	326 L
	45-115 kg
	Thruster
	3 Fixed

SUPKIDS	
	10'6" x 23" RACER
	4.75"
	14.5"
	180 L
	25-80 kg
	Single
	Race 23"



IT'S TIME TO GO

CHOOSE YOUR SIZE !



**DELUXE
DOUBLE CHAMBER**
(Safer, ultra stiff
and light)



**DELUXE
SINGLE CHAMBER**
(Stiff and light)



TIKHINE
(Performance
art you can ride)



NEW
**ZEN
DOUBLE CHAMBER**
(Safer, extra rigid,
price point)



**ZEN
SINGLE CHAMBER**
(Stripped to the
core essentials)

NEW 12'0" x 33"

DDC / DSC

Great for those learning to paddle or people trying to surf small waves up to 3 feet.

NEW 11'2" x 31+"

DDC / DSC / TIKHINE / ZDC /
ZSC / DSC WS / ZSC WS

Incredibly fast outline, which also provides abundant stability. The + also stands for the squarer tail shape which makes turning incredibly easy.

NEW 10'8" x 33"

DDC / DSC / ZDC / ZSC /
DSC WS

A popular entry-level size, perfect for schools and centres that want 1 board that does it all.

NEW 10'4" x 32"

DSC

The new wider nose of the 10'4" provides a steady paddle sensation without compromising its maneuverability. The narrow width increases paddle efficiency and tracking.

10'2" x 31"

TIKHINE

This fun compact boards' wide tail makes it easy to stepback and make quick fun turns.

NEW 10'0" x 34"

DSC

Suited for riders up to 100kg, the 10'0" is versatile for cruising, yoga, fitness and surfing small waves.

Rocio Tarodo, Bart De Zwart Wissanu Wisetputtasat Rayong, Thailand

IS THIS THE RIGHT BOARD FOR ME?

- Straight outlines help to keep the paddle closer to the board, improving tracking, trim and speed.
- Wider tails for easier and faster turning, wider noses for extra stability.
- Fun glide for cruising, stable shapes for all, easy to maneuver.
- Different sizes and constructions for all rider types and expectations.

ART YOU CAN RIDE

"Painting is like writing a diary for me about all my experiences, journeys discovering exotic places & different cultures around the world. That's how I found my very own style. A technique with special acrylic pens allows me to bring my impressions of the stunning nature of Hawaii, the animating rough north sea of Sylt or the sand desert of Fuerteventura onto canvas. My paintings often tell a story. The viewer on a closer look always discovers new context in the flowing lines."

As an high performance athlete doing SUP races I always want to be the fastest, in the art I find the peace, take my time...
For me it's the perfect balance.

The "Tikhine" is the result of an amazing collaboration with Starboard, being able to combine my two biggest passions presenting my art on the best boards.

Sonni Hönscheid

Sonni Hönscheid



Shoulder carry strap



Paddle holder



Free lightweight leash



Flat carry handle



Matching Tikhine paddle



TIKHINE SUN



TIKHINE WAVE



Tikhine Inflatables are built light and include a built in shoulder carry strap making it effortless to carry the board to the water.

The board's carry handle is flat, well suited for yoga exercises and relaxing poses. And it offers the possibility to attach your paddle when not using it.

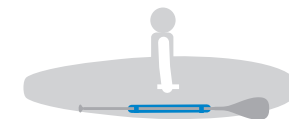

NEW

Mini GO

Good thing, small package

- More convenient to travel with.
- Easier to store.
- More comfortable to carry on the back.
- New 4 piece paddle that fits in the smaller bag.

CONSTRUCTION : DELUXE SINGLE CHAMBER
ZEN SINGLE CHAMBER

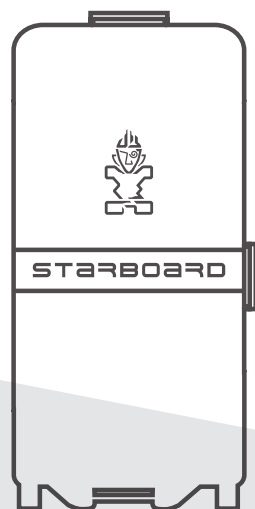

↓ **50%
SMALLER**



*4-piece paddle is not included in the board's packages

IGO INFLATABLE

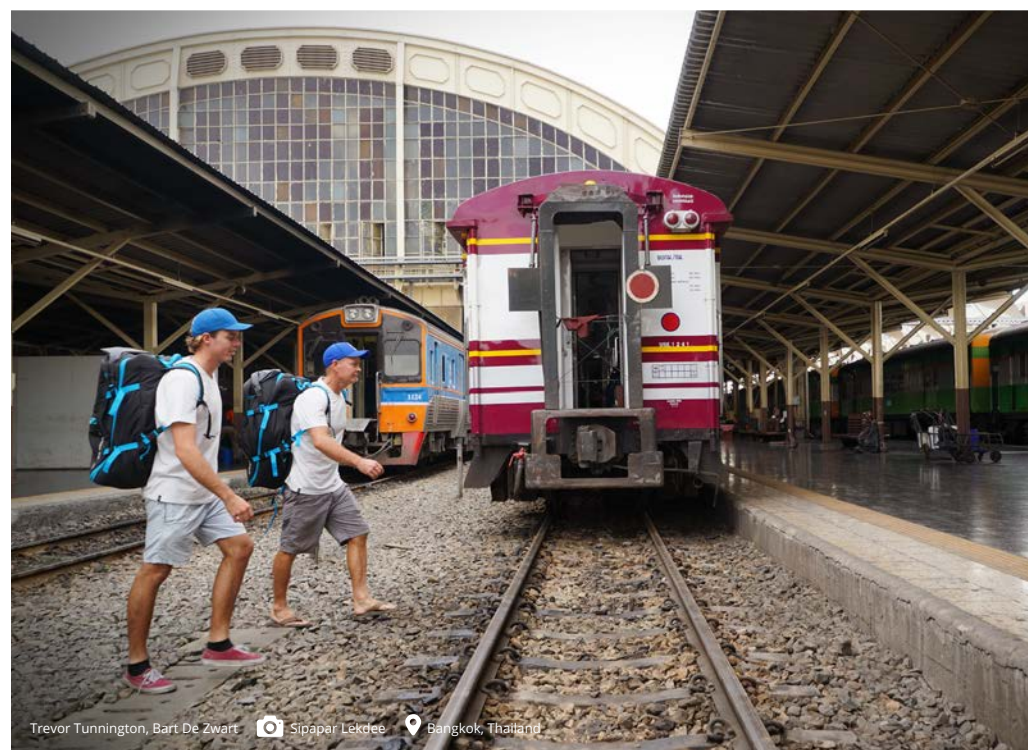



Trevor Tunnington, Bart De Zwart Sipaper Lekdee Bangkok, Thailand

2021 STARBOARD SUP 123

PIONEER EVERYWHERE

AN EXPLORER'S FAVORITE TRANSPORTATION

Bart De Zwart  Wissanu Wisetputtasat  Rayong, Thailand

IS THIS THE RIGHT BOARD FOR ME?

- **It's an explorer's favourite transportation.** Ideal for short or long distances, flat or small chop, the Touring makes the journey possible!
- The wider nose and squarer tail make the Touring boards more stable, specially for harsh conditions like side chop and moderate winds.
- New Touring S and L outlines introduce a new sporty design, meant for fast cruising and for smaller, lighter paddlers; as well as a wider, more robust design for bigger paddlers and those carrying heavy equipment.
- The edge release technology reduces drag by creating a laminar flow behind the board.
- **The welding technology makes the board stronger and last longer.**



**DELUXE
DOUBLE CHAMBER**
(Safer, ultra stiff
and light)



**DELUXE
SINGLE CHAMBER**
(Stiff and light)



TIKHINE
(Performance
art you can ride)



**NEW
ZEN
DOUBLE CHAMBER**
(Safer, extra rigid,
price point)



**ZEN
SINGLE CHAMBER**
(Stripped to the
core essentials)

NEW 14'0" x 32" TOURING L
ZDC

The gained stability and volume from the wider outline do not compromise the glide of the board making sure it remains an explorer's favorite choice.

NEW 14'0" x 30" TOURING
DDC / DSC

Fastest glide for riders up to 120kg, perfect for carrying gear for long distance paddles.

NEW 14'0" x 28" TOURING S
DSC

Enables a proper paddling technique since it is easier to change the paddle from side to side. The new S line is the greatest crossover between a Touring and a Race board.

NEW 12'6" x 30" TOURING
DDC / DSC / TIKHINE / ZDC /
ZSC / DSC WS

Suited for riders up to 110kg, 12'6" combines a balance of speed, stability and maneuverability.

NEW 12'6" x 28" TOURING S
DSC

Enables a proper paddling technique since it is easier to change the paddle from side to side. The new S line is the greatest crossover between a Touring and a Race board.

NEW 11'6" x 29" TOURING
DSC / TIKHINE / ZDC

Suited for riders up to 100kg, the 11'6" is lighter to carry and easier to turn.

AIRLINE CARBON

AIRLINE INFLATABLE

FASTER THAN MOST HARD BOARDS

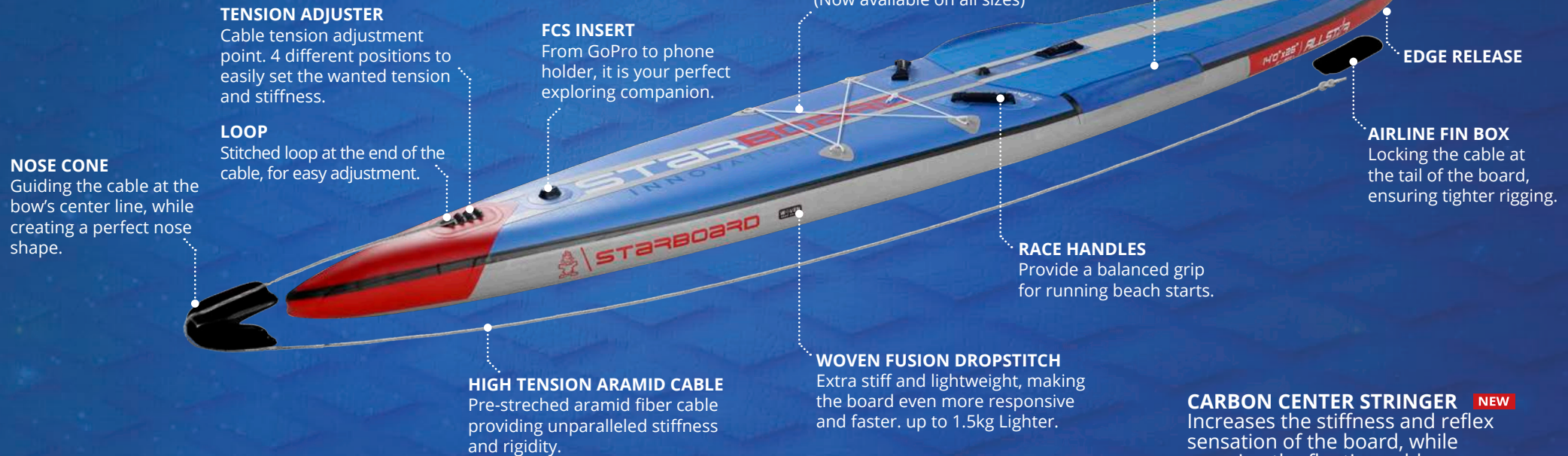

The free-flowing aramid cable locks the board in shape when inflated, creating a solid trustworthy hull sensation.

The patented Airline Technology utilises a pre-set free-floating cable. It is attached to the nose, goes under the bottom and ends at the fin box. The preset cable is slightly shorter than the board so when the board inflates, the cable comes under tension and stiffens the board significantly. We measured 1.8 cm less hull deflection in testing and World Champion Connor Baxter swears by it.

This efficient, lightweight technology is the future of inflatable performance boards.

"...with the new Starboard All Star and its patent pending Airline design coming on all their inflatable race boards, it looks like Starboard are closing the gap between carbon and air."

- SUPboarder Magazine



Free Lightweight Leash



AIRLINE CARBON

FASTER THAN MOST HARD BOARDS

Daniel Hasulyo  Wissanu-Wisetputtasat  Rayong, Thailand

IS THIS THE RIGHT BOARD FOR ME?

- NEW** • Composite outline, inflatable convenience.
- NEW** • Carbon bottom stringer for extra stiffness and reflex sensation.
- NEW** • Narrower tail for easier and faster buoy turning.
 - Built in standing tray with high EVA side rails increase stability and control.
 - Two race handles for running beach starts.

NEW 14'0" x 28" ALL STAR
DSC DOWNWIND

Ideal for those wanting to paddle downwind and still have the practicality of an inflatable board.

NEW 14'0" x 28" ALL STAR
DSC

Our widest outline provides added stability so the rider can reserve energy from balancing and instead use it to maximize paddle power.

NEW 14'0" x 26" ALL STAR
DSC

Our best selling inflatable race board gives enough stability to be in control when conditions get choppy, yet is fast and slippery to cover distances quickly.

NEW 14'0" x 24.5" ALL STAR
DSC

Extra fast from the narrow outline, insanely lightweight and now incredibly stiff from the carbon stringer the 24.5" is real companion for any serious racer.

NEW 12'6" x 27" ALL STAR
DSC

27" width has a slightly wider nose for extra pop in choppy water and wider tail for greater control and stability when buoy turning.

NEW 12'6" x 25.5" ALL STAR
DSC

Accelerates faster and it's more stable, while allowing faster side-to-side paddle changes when racing.



DELUXE
SINGLE CHAMBER



Nose Cone



Standing Tray



Edge Release

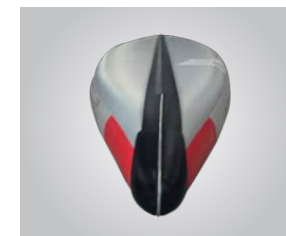

NEW
Carbon Stringer

NEW

THE WALL INFLATABLE

THE WALL

4.75" thick bottom with an added 2" wall, creating a 6.75" board. Ultra stiff, ultra stable & super comfortable.

This board follows the concept of our composite raceboards, where the standing area is recessed and therefore closer to the water surface.

By standing closer to the water level, the board feels more stable, especially in windy and choppy conditions.

This allows the paddler to save energy on their balance and focus on their paddle stroke technique.

RECESSED STANDING AREA

similar to our composite board's dugout concept, this new design allows you to stand close to the water, and to use the side walls to increase stability.

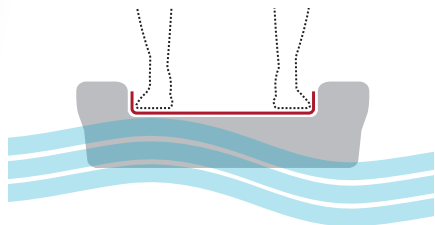

FCS INSERT

From GoPro to phone holder, it is your perfect exploring companion.

RAIL STEERING

The added side walls give extra comfort and control when rail steering, so it is easier to turn the board around without the need to step back to the tail.

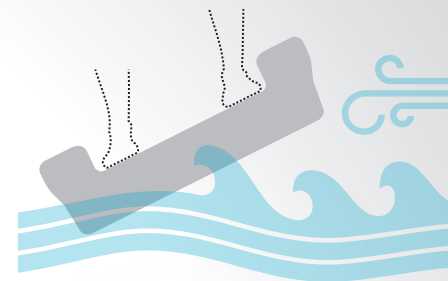

SECONDARY STABILITY

provided by the side walls on the top layer of the board. They keep the board from rolling when there is crosswind or side chop.

2.0" STIFFENING SIDE WALL

added 2" side walls on top of the 4.75" board increases the stiffness and rigidity of the board. It also provides secondary stability and extra volume for more buoyancy.

4.75" BACK RAILS

allow for easier and more comfortable step back turning, since it is easier to sink the tail.

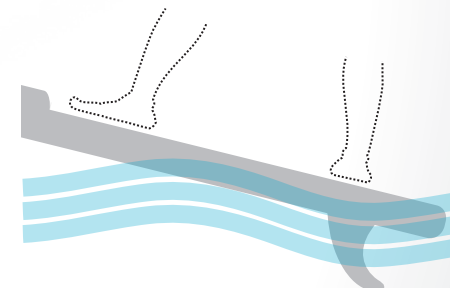

SURFING ON AIR

PUMP IT UP AND CATCH EVERY WAVE

An inflatable range that is dedicated to surf and foil performance.



SURF/ FOIL INFLATABLE

IS THIS THE RIGHT BOARD FOR ME?

- Surfing real waves and foiling the smallest bumps on inflatable boards has never been easier.
- With a thickness of 4.75", these boards provide enough buoyancy for the different conditions.
- Pump it up, catch a wave and fly over those bumps.
- There is a board for all tastes: SUP Surfing, SUP Foiling, Surf Foiling and Wing Foiling
- Foot strap inserts on 6'8" to enable easier and more reactive Wing Foiling
- Rail edge on Foil models for faster and easier take off
- Double chamber increases the stiffness for a more snappy reactive ride



SURF
DELUXE
DOUBLE CHAMBER



HYPER FOIL
NEW
DELUXE
SINGLE CHAMBER



SURF FOIL
NEW
DELUXE
SINGLE CHAMBER

9'5" x 32" SURF
DDC

Based on the 9'5" Wide Point composite outline, the narrow nose does not get caught through turns, wide standing area gives stability and pulled in tail makes for reactive turning.

NEW 6'8" x 27.5" HYPER FOIL
DSC

Short length combined with the wide nose and tail increases stability and makes it easier to control the foil angle to get up and riding early with little movement.

NEW 5'6" x 21.5" SURF FOIL
DSC

Versatile board, fast paddle speed yet still stable. Short length combined with the wide nose and tail increases stability and makes it easier to control the foil angle to get up and riding early with little movement.

* Leash and footstraps sold separately aftermarket.

LIFE IS BALANCE

TUNE IN TO YOUR BOARD AND BODY



Rocio Tarodo Trevor Tunington Pattaya, Thailand

Yoga Inflatables are built light and include a built in shoulder carry strap making it effortless to carry the board to the water. And it offers the possibility to attach your paddle when not using it.



IS THIS THE RIGHT BOARD FOR ME?

- Wide parallel outlines for stability, space to perform yoga poses & fitness workouts.
- Shoulder carry strap makes it easy to carry and enables a fix for the paddle when doing yoga.
- Provide great stability in flat water for a calm and relaxed yoga workout, while enabling the opportunity to take your yoga practice to another level with light chop and wind.
- This versatile yoga board is incredibly stable for Yoga practice. And at the same time it is a great all around board, since it shares the outline with the iGO of the same size.



YOGA
NEW
ZEN
SINGLE CHAMBER



TIKI MAT
NEW
ZEN
SINGLE CHAMBER



YOGA DOCK
NEW
ZEN
SINGLE CHAMBER

NEW 10'0" x 34" YOGA ZSC

With the extra inch in width, this boards is now more beginner friendly, specially for those who have never performed yoga in the water before.

8'0" x 38" TIKI MAT ZSC

Inspired from a traditional-shaped yoga mat, the Tiki Mat is the perfect platform to take your yoga from land to the water.

YOGA DOCK ZSC

Big enough to attach eight boards for a group class and an anchor point in the bottom to keep the station in position at all times. It also has many carry handles that make transport easier.

WHITE WATER CALLS

RIVERS ARE THE NEW FRONTIER



DELUXE
SINGLE CHAMBER
+ Double Layer



NEW
DELUXE
SINGLE CHAMBER

IS THIS THE RIGHT BOARD FOR ME?

Enough tail kick to turn easy and plenty of nose kick to handle steep drops. When you go down the stream, you may hit some rocks and smash some boulders so, we have your board protected with double layer technology and an extra sturdy fixed long low profile middle fin, that will be happy to take some punishment. A standing tray for extra stability and multiple front position handles are great for that extra performance.

11'0" x 34"

DSC DOUBLE LAYER

Enough width and length to make it both stable and fast for river racing.

10'11" x 31"

DSC

Our ultimate river racer board is now available in our Deluxe woven fusion dropstitch. This reduces the weight by up to 3 kg, making it faster than ever.

9'6" x 36"

DSC DOUBLE LAYER

Short, compact and stable, the 9'6" is designed to manoeuvre the most technical river runs.



Standing Tray

The Track & Slide center fin

NEW
Glue on 2.6" side fins

MAKE SUP AND WINDSURFING A FAMILY SPORT

THE MORE THE MERRIER



STARSHIP ALL WATER
NEW
ZEN
DOUBLE CHAMBER



TANDEM
NEW
ZEN
DOUBLE CHAMBER



STARSHIP FAMILY
NEW
ZEN
DOUBLE CHAMBER



VISION
NEW
ZEN
SINGLE CHAMBER

IS THIS THE RIGHT BOARD FOR ME?

Safety, strength and lightweight for the entire family (team)

Whether you want to compete in events, train with your team, or just paddle with friends and family, the Team paddle board range has a board for all. Our team boards are now **safer**, since they are built in a double chamber construction, which provides floatation in an emergency case. This makes them a perfect tool for schools and clubs to create team building, corporate events, and parties to engage more people on the water. The exclusive linear dropstitch **reduces the weight** of the board, which is easier to carry thanks to the multiple handles. Multiple inflation valves are also present, so all team members can help carry and pump up the board. The newly added mast inserts allow you to have both the fun of paddling and windsurfing, with **extra reinforcements** on the bottom of the board to increase the board's strength.

18'6" x 60" STARSHIP
ZDC ALL WATER

With plenty of volume and stability for up to 8 people, the pulled in nose outline and flat middle rocker delivers optimum glide and efficiency for multiple paddlers to explore, cruise and race.

16'0" x 32" TANDEM
ZDC

What better way to share the experience of SUP and/or Windsurf, than doing it together on the same board.

15'0" x 55" STARSHIP
ZDC FAMILY

The wider outline of the Starship Family gives the board great stability and provides enough space for riders to be able to paddle standing to each other.

11'2" x 38" VISION
ZSC

"The world's first underwater viewing window."

* Starship All Water, Starship Family and Tandem have windsurf inserts.

* Tandem and Vision come with Tiki pump.

* Only Vision comes with leash.

* Leash sold separately aftermarket.

2in1 SHOULDER STRAP & PADDLE HOLDER

CARRY BOTH THE BOARD AND PADDLE IN ONE

- Carry your board "hands free".
- Have your paddle attached to your board while walking to the water, doing yoga or swimming.
- No added board accessory, just 2 small loops on the carry strap.
- The new 2in1 carry strap combines both functions into one, without any extra weight, simplifying the product and making it user friendly.



SHOULDER STRAP

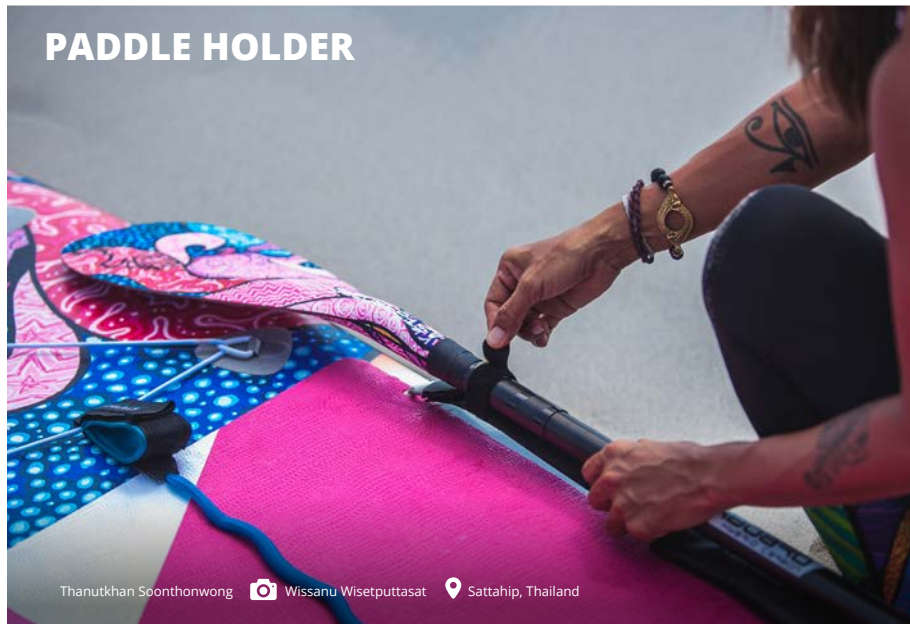

PADDLE HOLDER

Thanutkhan Soonthonwong 📷 Wissanu Wisetputtasat 📍 Sattahip, Thailand

TIKI PUMP

- **EFFICIENT**
- **EASY**
- **COMFORTABLE**
- **NET POSITIVE**

- Ultra efficient airflow with the cylinder placed outside of the chamber, creating space for a better flow inside the pump.
- Extra comfortable, wide handles, carefully positioned at the best angle to pump all the way to 18PSI.
- Wide stabilizer base, detachable for easy storing.
- Anti flap hose attached directly to the pump's body.
- Double and single action.
- Net positive handles and bases, made with fishing nets retrieved from the Indian ocean.
- Valve adapter for SUP and Wingboarding.



SUP BOARD
hose



NEW
FREEWING
hose



RE-COVER BAG

- LIGHT
- STRONG
- LARGE

The ultra light Re-Cover Bag is designed to minimize weight, yet maximize comfort and strength, resulting in the very best back pack carrying experience.

Utilizing "Rip Stop" technology to further strengthen the solid 450D material, we have an amazingly strong/light combination. Thanks to our partner "Waste2Wear" for making this breakthrough possible with upcycled plastic bottles, showcasing futuristic thinking. Yes, it also rolls up into a small, light and easy-to-transport item.

* Allstar Airline bag is wider to fit the EVA side rails when folded.



Padded Cover

Inside/Outside Compression Belt



FABRIC MADE FROM RECYCLED PLASTIC BOTTLES
ULTRA DURABLE RIPSTOP TECHNOLOGY



Strap Free System
Storing excess straps when not carrying the board.

Hiking Straps
Ergonomically curved shape to remove neck pain while ensuring good stability on the shoulders.

Reinforced Diamond PVC fabric
For increased durability when transporting.

Back Support
Ergonomically shaped. Perfect when hiking on long distances. Adjust it tight around your waist to reduce impact on your back.



Roller Wheels

INFLATION

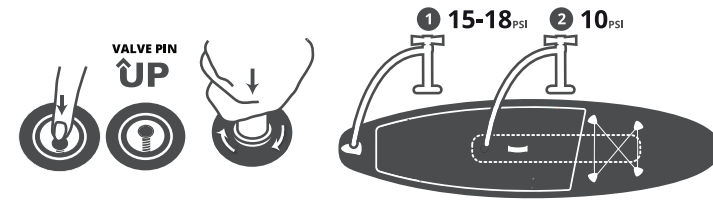

HOW TO ASSEMBLE THE TIKI PUMP

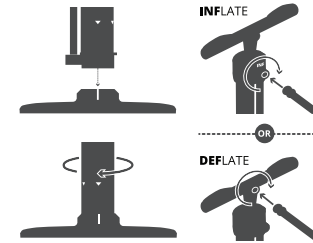

PUMPING TECHNIQUE

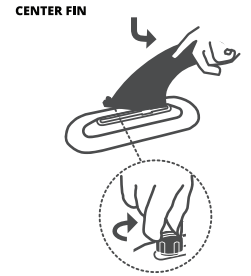
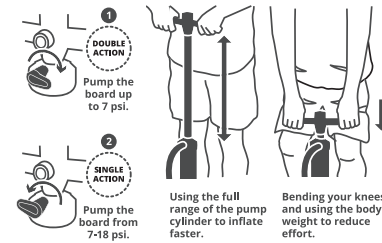

PADDLE TIPS

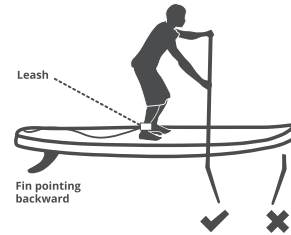

NEW

Beginner Guide Screened inside every inflatable board bag.

DEFLATION & STORAGE

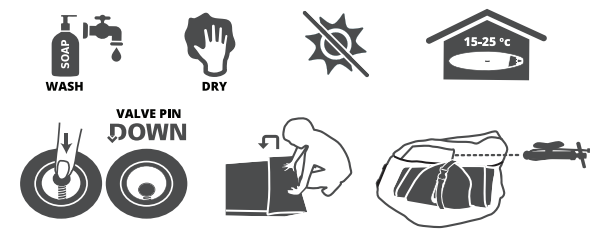

OUR HARD BOARDS, ALWAYS AHEAD



BEST SELLERS

GO

P. 48-49

The friendly fun board that makes any paddler feel PRO



BEST SELLERS

TOURING

P. 50-53

Ideal for short or long distances, flat or small chop, the Touring makes the journey possible!



WIDE RIDE SURF

P. 54-55

The Wide Ride range not only makes it easy to surf but surf better than you have before!



WEDGE SURF

P. 56-57

A versatile range for big to small conditions, best suited for beginner and intermediate riders.



PRO SURF

P. 58-59

Performance shapes for serious riders seeking world-class waves.



HYPER NUT SURF

P. 60-61

Proven innovative shapes with inverted rails. Offers the stability from a larger board and performance of a smaller board.



LONGBOARD SUP,SURF

P. 62-63

SUP: Designed to perform in waves from 1ft small beach breaks to head high reef breaks.
SURF: High performance yet versatile boards to suit a large range of surf and riders. We know you will love the Longboard!



ALL STAR SURF / ALL WATER

P. 66-69

High-performance race shapes designed by world-class athletes.



SPRINT FLAT WATER

P. 70-73

The ultimate speedster for flat water and chop. Instant acceleration, amazing top-end speed.



ACE CHOP WATER

P. 74-77

The downwind game-changer for choppy water and open-ocean conditions.



FOIL FOIL SURF V2

P. 78-79

Short lengths make it incredible easy to travel with, combined together with foil and foil wing options.



FOIL HYPER FOIL

P. 80-81

Undeniable platform for those entry-level learning to foil up to the world's most progressive team riders.



FOIL HYPER NUT FOIL 4in1 HYPER NUT SURF AND FOIL

P. 82-83

Designed to offer:
• Windsurfing (only 4in1)
• Windsurf Foiling (only 4in1)
• SUP Surfing
• SUP Foiling



SUPKIDS

P. 84-85

Small boards for small rippers



SUP WINDSURFING

P. 86-87

It's time to hold the wind in your arms



WING FOIL/ WING 4in1

P. 90-91

Early take off, superb balance while riding, easy touch down and fast relaunching.

BLUE CARBON PRO NEW

We set out to create a construction with the very lowest weight, best response and strongest build.

- LIGHTEST AND STRONGEST TECHNOLOGY AT THE HIGHEST LEVEL
- FULL DECK BIAXIAL CARBON LAMINATED IN THE STANCE
- FULL DECK, BOTTOM, RAIL PVC SANDWICH

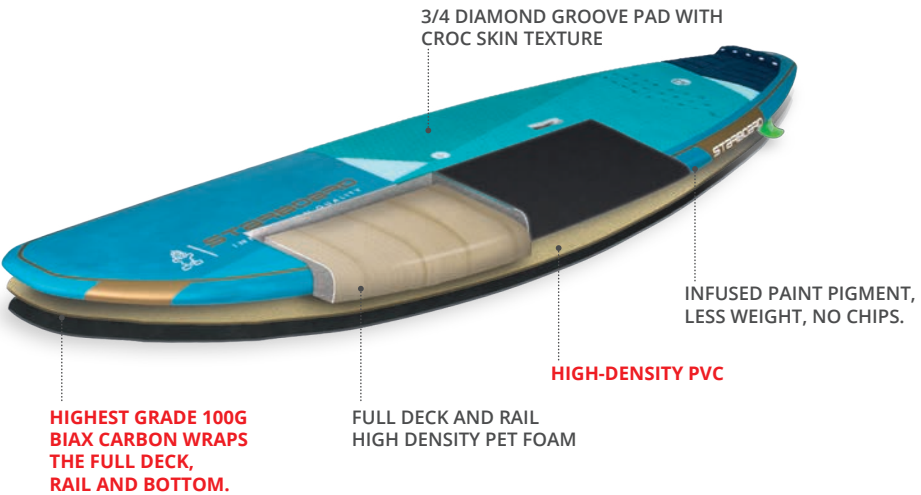

BLUE CARBON NEW

The best value full carbon construction we have ever produced.

- LIGHTWEIGHT
- FULL CARBON
- STRONG AND DURABLE

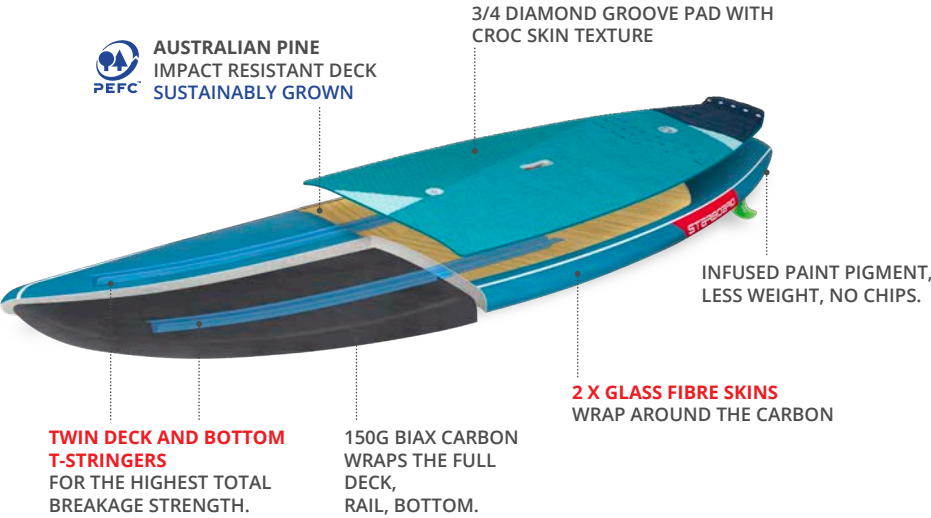

CARBON TOP

Lightness you can feel

- INCREDIBLY LIGHTWEIGHT
- FULL DECK BIAXIAL CARBON WRAP
- WOOD STANDING AND GLASS REINFORCEMENTS

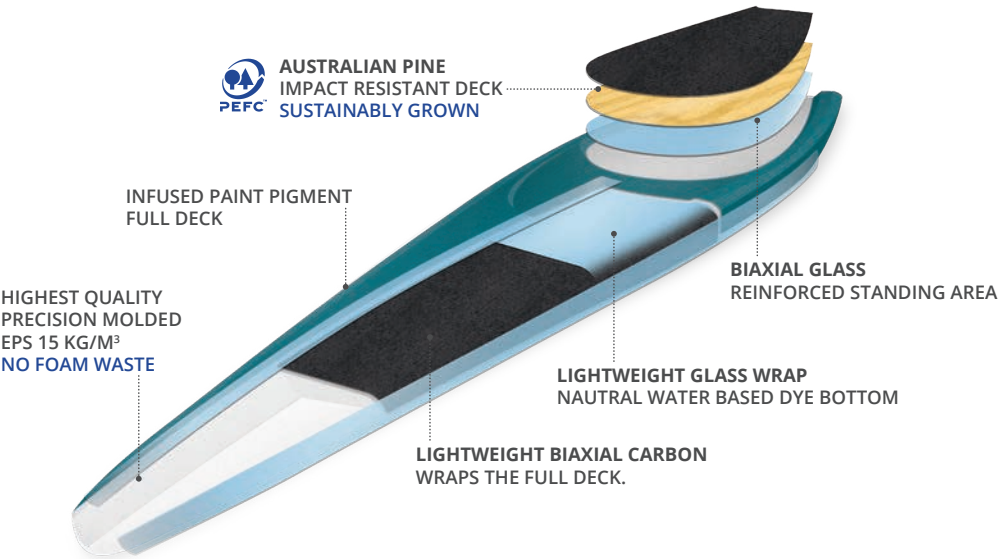

STARLITE NEW

- ULTRA DURABLE, SCRATCH AND IMPACT RESISTANT WOVEN RAIL PROTECTION - THE STRONGEST RAIL EVER TESTED
- TWIN T-STRINGER DECK AND BOTTOM - PROTECTS AGAINST TOTAL BREAKAGE
- FULL AUSTRALIAN PINE DECK - INCREASES OVERALL BREAKAGE STRENGTH.

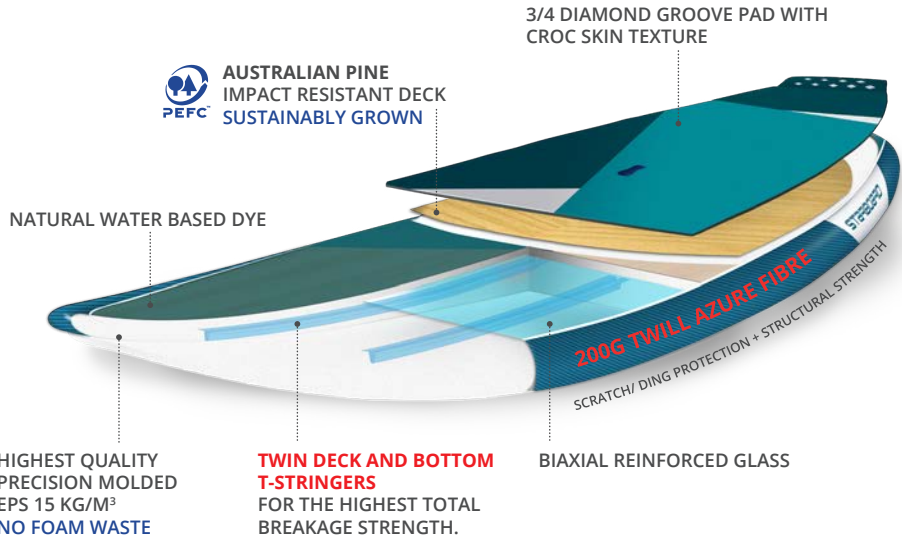

PINE TEK

- NATURAL UNI-DIRECTIONAL FLAX FIBER RAILS – IMPROVED HULL STRENGTH AND PROTECTS AGAINST TOTAL BREAKAGE.
- FULL PINE WOOD DECK – EXTRA IMPACT RESISTANCE AND RIGIDITY
- AVAILABLE ON THE TOURING PINE TEK

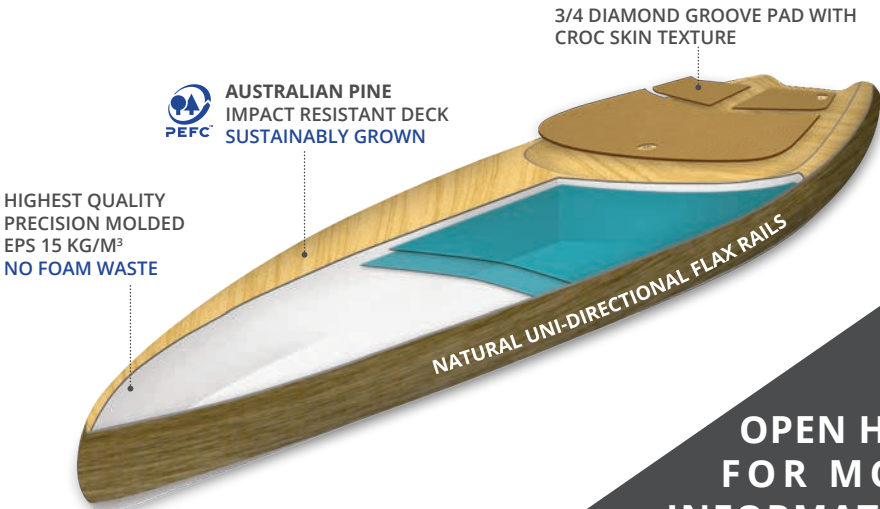

OPEN HERE FOR MORE INFORMATION

HARD BOARD

GO <div>BEST SELLERS</div>					TOURING <div>BEST SELLERS</div>										WIDE RIDE					WEDGE				
	12'0" x 34" 12'0" x 30"	11'2" x 32"	11'2" x 28"	10'8" x 31"	10'2" x 29"	14'0" x 30"	12'6" x 31"	12'6" x 29"	11'6" x 29"	14'0" x 30" <div>NEW</div> WATERLINE	14'0" x 28" WATERLINE	12'6" x 28" WATERLINE	14'0" x 28" <div>NEW</div> GENERATION	12'6" x 28" GENERATION	11'0" x 36" AVANTI	10'0" x 34" WHOPPER	9'8" x 30" BLEND <div>ELEMENT</div>	9'4" x 33" WHOPPER	8'3" x 30" POCKET ROCKET	11'2" x 32"	10'5" x 32"	10'2" x 32" <div>NEW</div> 9'2" x 32"	8'7" x 32" <div>NEW</div>	
Thickness:	4.8"/ 4.6"	4.7"	4.5"	4.5"	4.4"	7.2"	7.9"	7.9"	7.8"	7.6"	7.4"	7.5"	6.3"	6.3"	5"	4.3"	4.1"	4.7"	4.4"	4.6"	4.6"	4.6"/ 4.5"	4.4"	
Tail Width:	18.9"/ 16.6"	20.2"	17.7"	18"	17.1"	17.5"	20.5"	19.3"	21.1"	24.5"	23.4"	24.7"	13.8"	16.5"	19.1"	18.5"	17.5"	17.7"	18.2"	16.5"	16.6"	16.6"/ 18.4"	18.5"	
Volume:	256 L/ 221 L	217 L	190 L	192 L	177 L	290 L	284 L	274 L	245 L	284 L	259 L	224 L	285 L	249 L	243 L	174 L, Lite tech 171 L	146 L	178 L	135 L	198 L	178 L	183 L/ 160 L	143 L	
Rider weight:	70-130 kg/ 60-100kg	60-105 kg	45-95 kg	55-100 kg	50-95 kg	60-120 kg	55-110 kg	50-100 kg	45-90 kg	50-115 kg	50-105 kg	40-90 kg	50-110	50-100 kg	65-130 kg	60-110 kg	45-90 kg	50-100 kg	45-85 kg	60-115 kg	55-105 kg	55-105 kg/ 50-100 kg	45-95 kg	
Fin Set Up:	Single	Single	Single	Single	Single	Single	Single	Single	Single	Single	Single	Single	Thruster	Thruster	Thruster	Thruster	Thruster	Thruster	Thruster, Quad	Thruster	Thruster	Thruster	Thruster, Quad	
Fins:	9"	8" ASAP : 9"	8"	Race 23" ASAP: 9"	Race 23"	Dol-fin	Dol-fin	Dol-fin	Dol-fin	Carbon top: Race Ultra Lite Tech: Dol-fin	Carbon top: Race Ultra Lite Tech: Dol-fin	Carbon top: Race Ultra Lite Tech: Dol-fin	Carbon top: 230/ 5.5" Lite Tech: 8" 5.5"	Carbon top: 230/ 5.5" Lite Tech: 8" 5.5"	Center: 170 ASAP: 6 ^{3/4} "	Side: 5.5"	Center: 170 ASAP: 6 ^{3/4} "	Side: 4.7"	Center: 170 ASAP: 6 ^{3/4} "	Side: 4.5"	Center: 170 ASAP: 6 ^{3/4} "	Side: 4.7"	Center: 170 ASAP: 6 ^{3/4} "	Side: 4.7"

PRO												HYPER NUT						FOIL FOIL SURF V2						HYPER FOIL						HYPER NUT FOIL 4in1		HYPER NUT SURF AND FOIL		SUPKIDS				SUP WINDSURFING																																																																																																																																																																																																																																																																																																																																																																																																																																																																																																																																																																																																																																																																																																																																																																																																																																																																																																																																																																																																			
NEW		NEW		NEW		NEW		NEW		NEW		NEW		NEW		NEW		NEW		NEW		NEW		NEW		NEW		NEW		NEW		NEW		NEW		NEW		NEW		NEW		NEW		NEW		NEW		NEW		NEW		NEW		NEW		NEW		NEW		NEW		NEW		NEW		NEW		NEW		NEW		NEW		NEW		NEW		NEW		NEW		NEW		NEW		NEW		NEW		NEW		NEW		NEW		NEW		NEW		NEW		NEW		NEW		NEW		NEW		NEW		NEW		NEW		NEW		NEW		NEW		NEW		NEW		NEW		NEW		NEW		NEW		NEW		NEW		NEW		NEW		NEW		NEW		NEW		NEW		NEW		NEW		NEW		NEW		NEW		NEW		NEW		NEW		NEW		NEW		NEW		NEW		NEW		NEW		NEW		NEW		NEW		NEW		NEW		NEW		NEW		NEW		NEW		NEW		NEW		NEW		NEW		NEW		NEW		NEW		NEW		NEW		NEW		NEW		NEW		NEW		NEW		NEW		NEW		NEW		NEW		NEW		NEW		NEW		NEW		NEW		NEW		NEW		NEW		NEW		NEW		NEW		NEW		NEW		NEW		NEW		NEW		NEW		NEW		NEW		NEW		NEW		NEW		NEW		NEW		NEW		NEW		NEW		NEW		NEW		NEW		NEW		NEW		NEW		NEW		NEW		NEW		NEW		NEW		NEW		NEW		NEW		NEW		NEW		NEW		NEW		NEW		NEW		NEW		NEW		NEW		NEW		NEW		NEW		NEW		NEW		NEW		NEW		NEW		NEW		NEW		NEW		NEW		NEW		NEW		NEW		NEW		NEW		NEW		NEW		NEW		NEW		NEW		NEW		NEW		NEW		NEW		NEW		NEW		NEW		NEW		NEW		NEW		NEW		NEW		NEW		NEW		NEW		NEW		NEW		NEW		NEW		NEW		NEW		NEW		NEW		NEW		NEW		NEW		NEW		NEW		NEW		NEW		NEW		NEW		NEW		NEW		NEW		NEW		NEW		NEW		NEW		NEW		NEW		NEW		NEW		NEW		NEW		NEW		NEW		NEW		NEW		NEW		NEW		NEW		NEW		NEW		NEW		NEW		NEW		NEW		NEW		NEW		NEW		NEW		NEW		NEW		NEW		NEW		NEW		NEW		NEW		NEW		NEW		NEW		NEW		NEW		NEW		NEW		NEW		NEW		NEW		NEW		NEW		NEW		NEW		NEW		NEW		NEW		NEW		NEW		NEW		NEW		NEW		NEW		NEW		NEW		NEW		NEW		NEW		NEW		NEW		NEW		NEW		NEW		NEW		NEW		NEW		NEW		NEW		NEW		NEW		NEW		NEW		NEW		NEW		NEW		NEW		NEW		NEW		NEW		NEW		NEW		NEW		NEW		NEW		NEW		NEW		NEW		NEW		NEW		NEW		NEW		NEW		NEW		NEW		NEW		NEW		NEW		NEW		NEW		NEW		NEW		NEW		NEW		NEW		NEW		NEW		NEW		NEW		NEW		NEW		NEW		NEW		NEW		NEW		NEW		NEW		NEW		NEW		NEW		NEW		NEW		NEW		NEW		NEW		NEW		NEW		NEW		NEW		NEW		NEW		NEW		NEW		NEW		NEW		NEW		NEW		NEW		NEW		NEW		NEW		NEW		NEW		NEW		NEW		NEW		NEW		NEW		NEW		NEW		NEW		NEW		NEW		NEW		NEW		NEW		NEW		NEW		NEW		NEW		NEW		NEW		NEW		NEW		NEW		NEW		NEW		NEW		NEW		NEW		NEW		NEW		NEW		NEW		NEW		NEW		NEW		NEW		NEW		NEW		NEW		NEW		NEW		NEW		NEW		NEW		NEW		NEW		NEW		NEW		NEW		NEW		NEW		NEW		NEW		NEW		NEW		NEW		NEW		NEW		NEW		NEW		NEW		NEW		NEW		NEW		NEW		NEW		NEW		NEW		NEW		NEW		NEW		NEW		NEW		NEW		NEW		NEW		NEW		NEW		NEW		NEW		NEW		NEW		NEW		NEW		NEW		NEW		NEW		NEW		NEW		NEW		NEW		NEW		NEW		NEW		NEW		NEW		NEW		NEW		NEW		NEW		NEW		NEW		NEW		NEW		NEW		NEW		NEW		NEW		NEW		NEW		NEW		NEW		NEW		NEW		NEW		NEW		NEW		NEW		NEW		NEW		NEW		NEW		NEW		NEW		NEW		NEW		NEW		NEW		NEW		NEW		NEW		NEW			

RACE SURF/ALL STAR									FLAT WATER/SPRINT					CHOPPY WATER/ACE			LONGBOARD SUP			SURF		WING FOIL		4in1
	<div>NEW</div> 14'0" x 28" 14'0" x 26"	<div>NEW</div> 14'0" x 24.5"	<div>NEW</div> 14'0" x 23"	<div>NEW</div> 14'0" x 22.5"	12'6" x 28"	12'6" x 26" 12'6" x 24.5"	12'6" x 23.5"	12'6" x 23"	<div>NEW</div> 14'0" x 25"	14'0" x 23.5"	<div>NEW</div> 14'0" x 21.5"	<div>NEW</div> 14'0" x 19.75"	12'6" x 23" 12'6" x 21.5"	14'0" x 27" 14'0" x 24.5"	14'0" x 23"	<div>NEW</div> 14'0" x 21.5"	<div>NEW</div> 10'0" x 31"	10'0" x 29" 9'0" x 28"	<div>NEW</div> 9'0" x 26"	9'3" x 22.5" 9'1" x 22"	<div>NEW</div> 7'0" x 30" 6'7" x 28" WINGBOARD	<div>NEW</div> 5'8" x 25" 4'6" x 25" WINGBOARD	<div>NEW</div> 10'4" x 32" WINGBOARD 4in1	
Thickness:	8.5"/ 10.3"	10.3"	10.4"	10.8"	10.1"	9.4"/ 9.2"	9.2"	8.4"	11.1"	11.8"	12.2"	11.9"	10.1"/ 11"	11.7"/ 11"	10.4"	11.2"	3.6"	3.3"/ 3.3"	3.2"	2.8"/ 2.8"	4.3"/ 4.2"	3.8"/ 3.8"	5"	
Tail Width:	16.1"/ 15.2"	14.6"	14"	13.4"	17.9"	16.8"/ 16.5"	16"	15.3"	16.8"	16.8"	15.8"	14.6"	19"/ 17.9"	7.4"/ 7"	6.7"	9.3"	18.5"	16.5"/ 16.5"	15.7"	14.6"/ 14"	24.6"/ 23.5"	21"/ 21.7"	20.3"	
Volume:	331 L/ 340 L	320 L	299 L	289 L	340 L	313 L/ 300 L	283 L	242 L	349 L	354 L	332 L	295 L	280 L/ 263 L	386 L/ 329 L	333 L	316 L	147 L	123 L/ 101 L	95 L	65 L/ 59 L	140 L/ 115 L	88 L/ 69L	220 L	
Rider weight:	80-110 kg/ 70-105 kg	60-90 kg	50-80 kg	40-65 kg	75-105 kg	70-95 kg/ 50-90 kg	40-80 kg	40-70 kg	70-105 kg	70-100 kg	50-90 kg	50-80 kg	45-85 kg/ 45-75 kg	60-100 kg/ 55-90 kg	40-80 kg	40-75 kg	50-110 kg	45-95 kg/ 45-85 kg	45-75 kg		50-110 kg/ 40-95 kg	40-85 kg/ 30-75 kg	45-105 kg	
Fin Set Up:	Single	Single	Single	Single	Single	Single	Single	Single	Single	Single	Single	Single	Single	Single	Single	Single	Thruster	Thruster	Thruster	Thruster	Foil	Foil	US Center fin box	
Fins:	Race Ultra	Natural Winner	Natural Winner	Natural Winner	Race Ultra	Natural Winner	Natural Winner	Natural Winner	Race Ultra	Race Ultra	Race Ultra	Race Ultra	Race Ultra	Race Ultra	Natural Winner	Natural Winner	Center: 185 Side: 4.5"	Center: 185 Side: 4.5"	Center: 185 Side: 4.5"	FCS 2 10" US BOX			Drake shallow 220 Drake shallow 320	

LITE TECH

- BEST-VALUE
- PRECISION MOLDED
- EXTRA STRONG

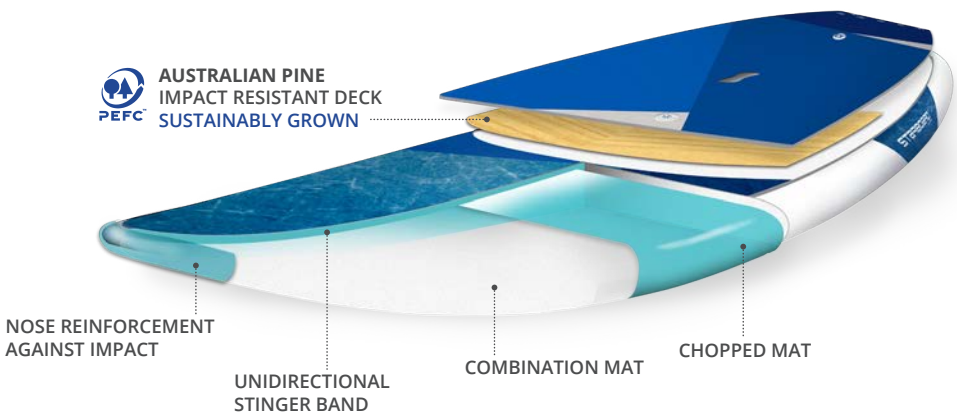

ASAP

NEW

- AS STRONG AS POSSIBLE
- SOFT RAIL
- HARD BOTTOM

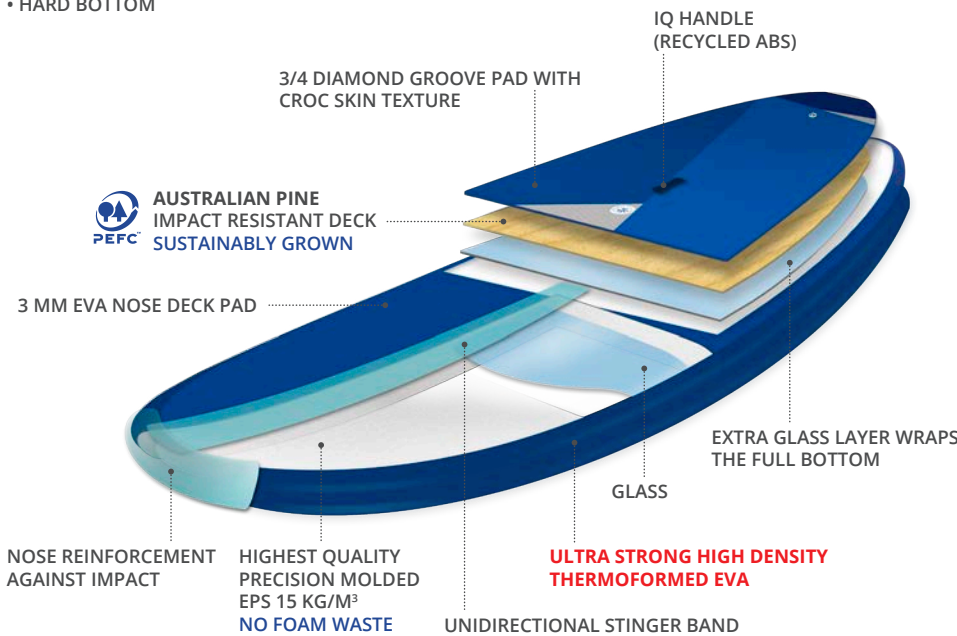

IS THIS THE RIGHT BOARD FOR ME?

- The perfect introductory board for paddlers who want to paddle fast and stay dry.
- This board makes paddling simple for the ultimate first time SUP experience.
- The best flat-water cruising and light ocean chop option.
- Great turnability provided by the wide tail platform which makes it easy to step back.
- Go Windsurf features mast track box, extended deck pad and US center fin boxes.

GO

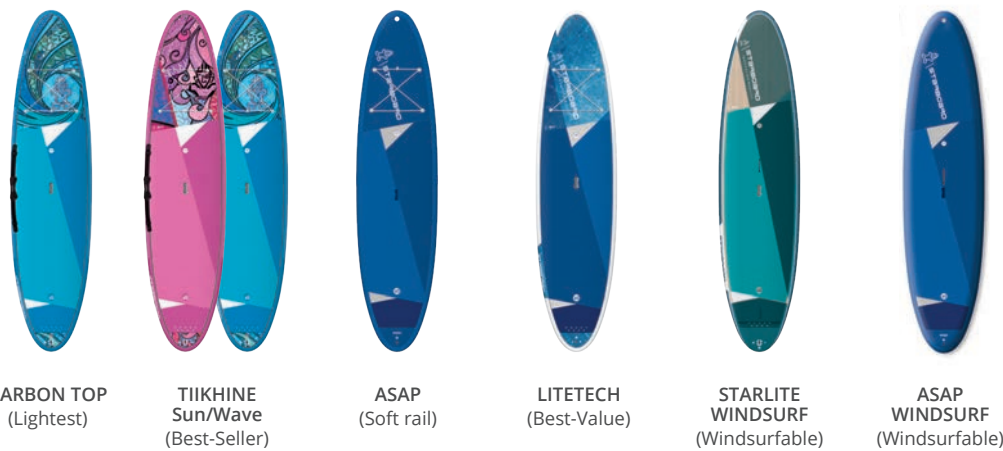

12'0" x 34"
ASAP / STARLITE WS / ASAP WS

Delivers performance with ease, replacing the Atlas Extra as the most stable shape in the range.

12'0" x 30"
ASAP / STARLITE WS / ASAP WS

The fastest GO board in the range, offering a fast and stable board in a traditional surf outline shape.

11'2" x 32"
CARBON TOP / TIKHINE / ASAP /
LITETECH / STARLITE WS / ASAP WS

A truly amazing board. The glide matches that of a 3 inch narrower board and its stability is tremendous due to the concave hull and boxy rails. Our wind-friendly SUP shape has more nose kick for greater lift over chop when windsurfing.

11'2" x 28"
CARBON TOP / TIKHINE

A more performance orientated board suited to ladies, lightweight riders that want fast glide and easy tracking from the narrower outline.

10'8" x 31"
CARBON TOP / TIKHINE / ASAP /
LITETECH / STARLITE WS

Quicker turning and easier to move around. A fast, nimble and effortless glide.

10'2" x 29"
CARBON TOP / TIKHINE

The light weight and shorter length offers easier maneuverability and fast turning.

PIONEER EVERYWHERE

FAST, SMOOTH AND STABLE TOURING

IS THIS THE RIGHT BOARD FOR ME?

- Our famous race board inspired outlines, made wider for more stability with options to carry gear and supplies.
- Ideal for short or long distances, flat or small chop, the Touring makes the journey possible!
- Suited for all skill levels that want the fastest glide to paddle distances quickly with comfortable stability and the option to carry gear along the journey.



NEW

CARBON TOP
(Lightness you can feel)



PINE TEK
(full wood deck showcases
the Australian Pine 0.6mm
Biaxial veneer)



TIKHINE
(Art you can ride)



LITE TECH
(Best-Value)

14'0" x 30"

CARBON TOP / PINE TEK

Longest length with the fastest glide and best tracking for riders up to 120kg.

12'6" x 31"

CARBON TOP / PINE TEK / LITE TECH

The most stable and widest design for heavier riders up to 110kg.

12'6" x 29"

CARBON TOP / PINE TEK

Balances speed and stability offering the most efficient glide for riders up to 100kg.

11'6" x 29"

CARBON TOP / PINE TEK / TIKHINE

Covers distance quickly and offers added maneuverability for lighter weight riders up to 90kg.

WATERLINE

AS SMOOTH AS SILK

NO SPLASH, HARDLY A RIPPLE



"It accelerates the water out of its path at an ever-increasing rate, giving the rider an effortless experience."
~Peter Murphy

Carsten Kurmis 📷 Andy Klotz 📍 Starnberger See, Germany

IS THIS THE RIGHT BOARD FOR ME?

- The Waterline is designed as a specialised flat-water touring paddle board, this board promises the smoothest and most relaxing paddling sensation in conditions up to shin high chop.
- A shape focused on achieving maximum speed and stability with no splash or sound.
- At 75% speed this hull is faster than our race boards, so in essence for most riders it's the quickest ride ever.

NEW 14'0" x 30" WATERLINE
CARBON TOP / LITETECH

The most stable flat-water touring board, suited for heavier riders and those that want extra balance for effortless cruising.

14'0" x 28" WATERLINE
CARBON TOP / LITETECH

Longer length delivers faster longer lasting glide. More stability and buoyancy to carry heavier gear.

12'6" x 28" WATERLINE
CARBON TOP / LITETECH

Lighter to carry and easier to manoeuvre both on and off the water. More manageable to store and transport.



CARBON TOP
(Lightness you can feel)



LITE TECH
(Best-Value)



Trevor Tunnington 📷 Diane Tunnington 📍 Sunshine Coast, Australia



IS THIS THE RIGHT BOARD FOR ME?

The Generation plays in 3 worlds; Surfing, Racing and Touring.

It will remind you of; the Longboard when surfing as the tail outline makes it respond with ease, the All Star when racing in all water conditions, the Touring when it comes to stability and user-friendliness.

Available in the lightest and fastest Carbon Top and the best value Lite Tech construction.

NEW 14'0" x 28" GENERATION
CARBON TOP / LITETECH

The best option for riders that want faster top speeds for racing and paddling longer distances when touring.

12'6" x 28" GENERATION
CARBON TOP / LITETECH

Remains the more maneuverable option, easier and faster to turn in the surf and nimble for lighter riders.



CARBON TOP
(Lightness you can feel)



LITE TECH
(Best-Value)



THE WIDE RIDE WITH REAL GLIDE

THIN RAILS ON WIDE BOARDS

Rocio Tarodo Nathan Lawrence Bali, Indonesia

IS THIS THE RIGHT BOARD FOR ME?

- Stable shapes for wave riding. The Wide Ride range not only makes it easy to surf but surf better than you have before!
- Wide Ride has a size for all rider weight and abilities; the bigger models produce the easiest glide and stability, while the smaller sizes deliver more control and manoeuvrability.
- The wider nose and tail outline makes it more stable and forgiving over the Wide Point range, while offering more glide into waves and smoothness rail-to-rail compared to the Hyper Nut range.



BLUE CARBON
(Lightest)



STARLITE
(Durable)



ASAP
(Soft rail)



LITE TECH
(Best-Value)



**ASAP
WINDSURF**
(Windsurfable)

11'0" x 36" AVANTI
BLUE CARBON / STARLITE / ASAP

Fun and easy glide, an incredibly stable board for heavier or multiple riders to cruise and surf.

10'0" x 34" WHOPPER
BLUE CARBON / STARLITE / ASAP /
LITE TECH

A highly popular, stable board which surprises with incredible wave riding ability.

9'8" x 30" BLEND ELEMENT
LITE TECH

The 9'8" is an ideal option for lighter riders wanting an all round board for cruising and surfing. The 30" width makes it responsive to maneuver and fast in the waves.

9'4" x 33" WHOPPER
BLUE CARBON / STARLITE / ASAP

Shorter length gives greater maneuverability with easier turning in the surf.

8'3" x 30" POCKET ROCKET
BLUE CARBON / STARLITE

Stable short board for riders looking for more progressive surfing in all conditions.

WEDGE

THE NEW EDGE!

- Thin rails, pin tails and shorter outline for top performance.
- Pro performance and feel without compromising stability or volume from the 32" width.
- A versatile range for big to small conditions, entry and intermediate to advanced riders.

IS THIS THE RIGHT BOARD FOR ME?

- The all new Wedge line upgrades the previous range of Wide Point boards. Sizing begins at 8'7" x 32" up to 11'2" x 32".
- These boards have a pro performance and feel without compromising stability or volume.
- All boards are 32" wide to provide float and stability for heavier riders to rip.
- A versatile range for big to small conditions, best suited for beginner and intermediate riders.
- Narrower nose and tail outline makes for faster & more responsive surfing over other ranges like the Wide Ride.



BLUE CARBON
(Lightest, Strongest)



STARLITE
(Durable)



LITETECH
(Best-Value)

11'2" x 32"

STARLITE

A versatile cruising board with the fastest glide into waves and smooth carving off the tail.

10'5" x 32"

LITE TECH

Fast, reactive and controlled; the stable surfing all-rounder.

NEW 10'2" x 32"

BLUE CARBON / STARLITE

Shorter length is easier to turn, pin tail is more responsive.

NEW 9'2" x 32"

BLUE CARBON / STARLITE

A favorite in the testing and development, it turned heads with its control and responsiveness.

NEW 8'7" x 32"

BLUE CARBON / STARLITE

Shorter, stable and sensitive. Combining comfort with high performance surfing.

SURF LIKE A PRO

HIT LIPS, THROW BUCKETS

Benoit Carpentier  Nathan Lawrence  Bali, Indonesia

IS THIS THE RIGHT BOARD FOR ME?

- NEW** • 021 Pro model has all new sizes and new design.
- Performance shapes for serious riders seeking world-class waves.
- For intermediate to high-skilled riders up to 120 kg.
- For larger clean hollow conditions, beach breaks down to smaller waves.



NEW
BLUE CARBON PRO
(Lightest and strongest)



STARLITE
(Durable)

NEW 9'0" x 30"

BLUE CARBON PRO / STARLITE

The biggest board in the range and the first pro design to go as wide as 30", designed for riders that want extra stability and float.

NEW 8'7" x 29.5"

BLUE CARBON PRO / STARLITE

The 8'7" doesn't feel like the second biggest board in the range, in fact far from it. Yes it has 135L to float a rider up to 110kg, but the performance is unmatched for a board of its size.

NEW 8'0" x 29"

BLUE CARBON PRO / STARLITE

Packs a surprising amount of volume for its size, making it a very viable option for riders that might normally be intimidated by going so short.

NEW 7'7" x 28"

BLUE CARBON PRO / STARLITE

Replaces both the 7'10"x28" and 29", and yet despite being shorter, it actually has 5 liters more float for riders up to 85kg. The 7'10" was the first size to be scaled up from the 6'8" and it was immediately a clear winner!

NEW 7'2" x 26.75"

BLUE CARBON PRO

Copying the length of the previous 7'2" and with the width of the 7'7", it makes it possible to rip like the best with a little extra comfort in stability.

NEW 6'8" x 24"

BLUE CARBON PRO

Designed to win, the 6'8" carved the way for the new Pro range. All other sizes are exactly scaled versions of this board, so any rider using a new 021 Pro can trust they share the same design and performance from the highest performing athletes in the world.

INNOVATE YOUR RIDE

WITH PATENTED SHAPE TECHNOLOGY

IS THIS THE RIGHT BOARD FOR ME?

- Proven innovative shapes with inverted rails.
- Offers the stability from a larger board and performance of a smaller board.
- Unique release points & speed bursts.



BLUE CARBON
(Lightest)



STARLITE
(Durable)

Blue Carbon is up to 1kg lighter than Starlite

9'0" x 31.5"

BLUE CARBON / STARLITE

9'0" is the longest and thus has the best glide, making it faster to paddle out to the surf and easier to paddle into waves early.

8'4" x 31.5"

BLUE CARBON / STARLITE

The 8'4" is ideal for riders up to 110kg, offering more glide into waves than the smaller models.

7'10" x 31.5"

BLUE CARBON / STARLITE

The 7'10" is our best selling model, offering enough stability with performance that rips.

7'6" x 30"

BLUE CARBON / STARLITE

The 7'6" is more maneuverable than the 7'10" and has more stability over the 7'0", ideal for riders up to 95kg.

7'0" x 28"

BLUE CARBON / STARLITE

A short board with a big bite. The 7'0" is the smallest in the line, designed for small to overhead surf.

IT'S TIME FOR A NEW OLD THING

CLASSIC STYLE, MODERN CONSTRUCTION



BLUE CARBON
(Lightest, Strongest)



STARLITE
(Durable)

IS THIS THE RIGHT BOARD FOR ME?

- High performance Longboard that is versatile, incredibly responsive and smooth to turn.
- Inspired by our legendary Starboard Surf Longboard model, designed to perform in waves from 1ft small beach breaks to head high reef breaks.
- Low volume rails, parallel outline and deep double concave create a board like no other in the range.
- As the Longboard has ultra thin rails, both Blue Carbon and Starlite feature twin T-stringers deck and bottom to increase the stiffness the total breakage strength.

NEW 10'0" x 31" LONGBOARD SUP Offers more volume and float for heavier riders up to 110kg.
BLUE CARBON / STARLITE

10'0" x 29" LONGBOARD SUP Carries more glide and speed from the longer length. The 29" width provides a wider platform with greater stability for heavier riders.
BLUE CARBON / STARLITE

9'0" x 28" LONGBOARD SUP Suited for lighter riders that want faster and reactive maneuverability.
BLUE CARBON / STARLITE

NEW 9'0" x 26" LONGBOARD SUP The nimble weapon for high skilled and lightweight riders up to 75kg.
BLUE CARBON / STARLITE

CLASSIC SURF SHAPE

ULTRA-LIGHT WEIGHT
2X WINNER OF THE ULTIMATE WATERMAN



NEW
BLUE CARBON PRO

IS THIS THE RIGHT BOARD FOR ME?

We designed the Longboard to have the perfect mix of modern day lightweight technology with a classic old school longboard feel. The Starboard Longboard is made to suit you because we designed these two models as high performance yet versatile boards to suit a large range of surf and riders. We know you will love the Longboard!

9'3" x 22.5" LONGBOARD SURF
BLUE CARBON PRO

A super high-performance longboard built to perform in waves from 1ft to 6ft and offers fast down-the-line surfing, as well as the ability to turn the board very loosely and powerfully off the top of the waves.

9'1" x 22" LONGBOARD SURF
BLUE CARBON PRO

The ultra-high performance, yet versatile longboard that is loved by beginner, intermediate and advanced surfers.

RACE CONSTRUCTION

CARBON SANDWICH NEW

- LIGHTEST WEIGHT
- EXTRA DURABILITY
- FLEX CONTROL

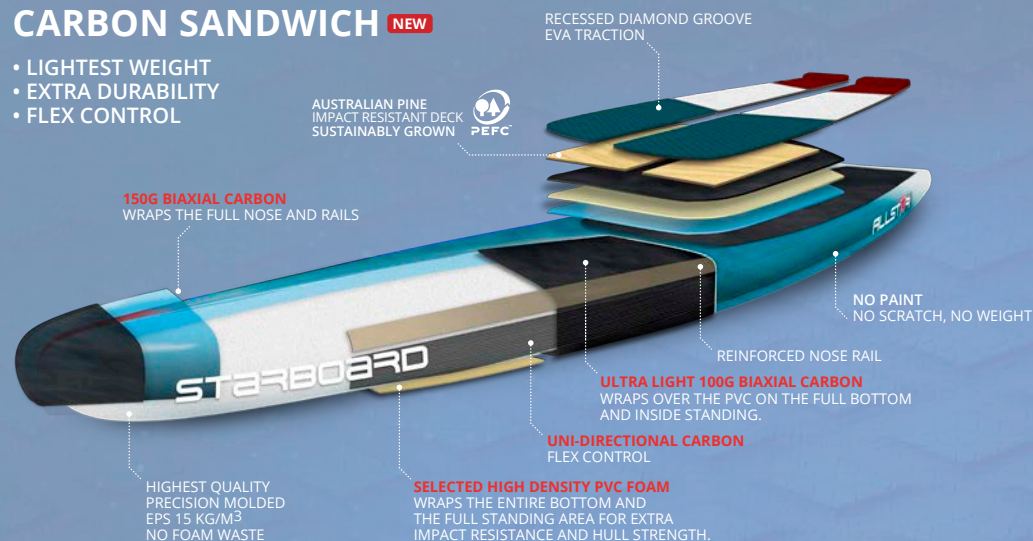

Features include:

- This is the lightest and strongest race board construction we have ever offered and is up to 500g lighter than the previous tech.
- Super light-weight 100g biaxial Carbon is laminated over the standing area and full bottom, while a stronger 150g Biaxial carbon wraps the nose and rail for the lightest weight, best strength ratio and most efficient flex.
- The mid-section of the board has stiffer UD Carbon side stringers to maintain the rocker in that critical area, thus optimizing glide.
- Thin high density PVC is used in the standing area and full bottom, reducing resin uptake and maximizing strength.
- Infused paint pigment means no paint is sprayed reducing the overall weight, paint chips and scratches.

MOST SANDWICH CONSTRUCTIONS



STARBOARD SANDWICH CONSTRUCTION



RECOMMENDED BY
WORLD CHAMPIONS

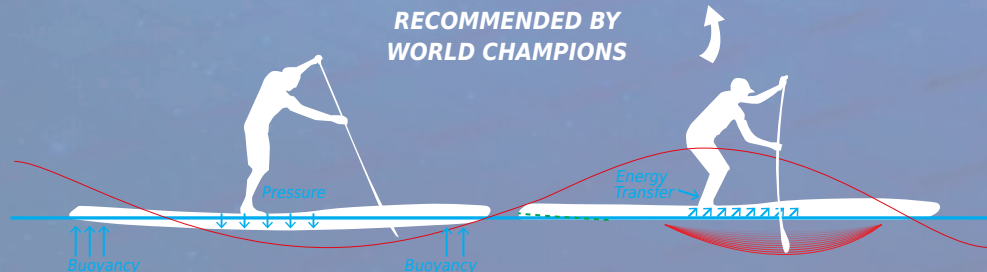

BOARD FLEXES ON DOWNSTROKE
STORING IT'S ENERGY.

BOARD RECOILS ON UPSTROKE
RELEASING IT'S ENERGY

This year we are introducing our new aftermarket scuppers that attach over the drainage holes for All Star, Sprint and Ace models for better drainage at high speeds. Scuppers are sold separately.

CARBON

- LIGHT WEIGHT
- FLEX CONTROL

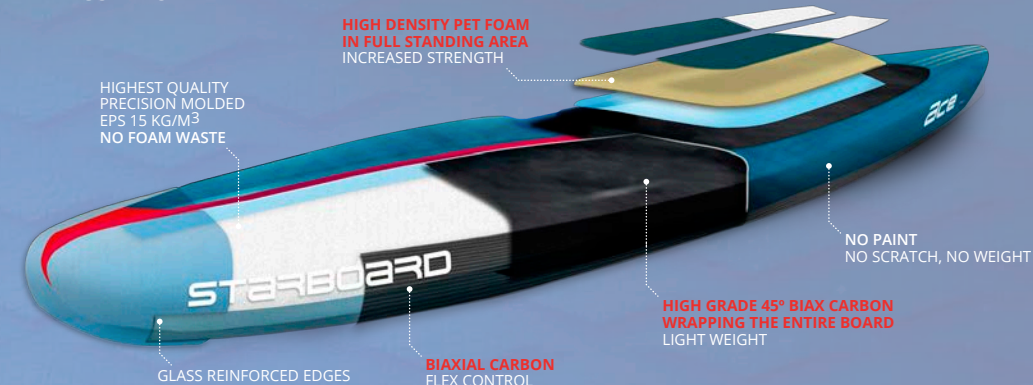

Features include:

- Full wrap of 150g Biaxial Carbon fabric is laminated over the entire hull. The Carbon are overlapped on the bottom, creating a center stringer for added stiffness.
- The mid section of the board has extra Biaxial Carbon that wraps both outside and inside the rail for further stiffness and overall hull strength.
- Impregnated paint pigment means no paint is sprayed reducing the overall weight, paint chips and scratches.
- High Density PET Foam in the full standing area increases strength and impact resistance.
- Wider reinforcements wrap the deck and bottom rail edges for greater durability, as well as extra reinforced drainage holes.
- Full Carbon technology that delivers lightweight and flex control.

WOOD CARBON

- GREAT STRENGTH
- COMPETITIVE WEIGHT
- VALUE OFFERING

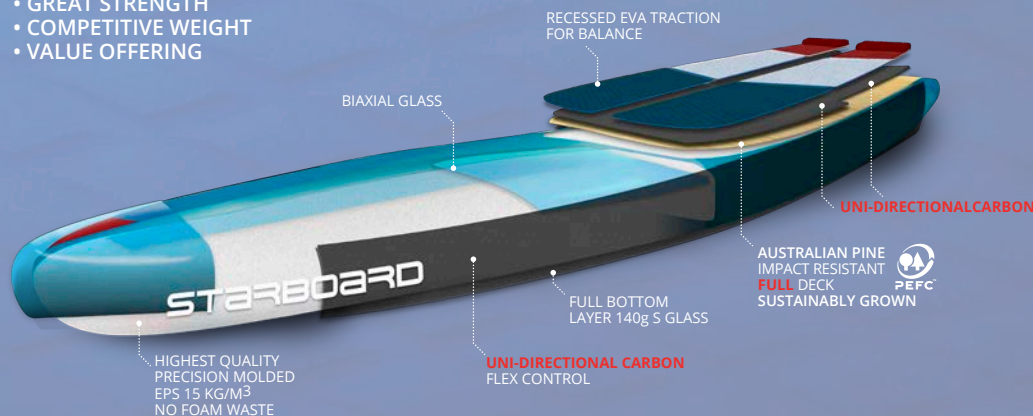

Features include:

- Australian Pine reinforcement is used on the full length of the standing area for extra impact strength against heel dents.
- New UD Carbon reinforced standing area provides extra durability and stiffness at the greatest impact zone.
- UD Carbon reinforcements cover the rail, increasing the strength longitudinally and offering faster recoil.
- The new Wood Carbon technology combines performance and great value at an amazing weight.

RACE





ONE BOARD ALL CONDITIONS

BE AN ALL-STAR AT EVERY RACE

Ultra-stable, unmatched speed.
High performance race shapes,
designed by world champion athletes.



CARBON SANDWICH
(Lightest Strongest)

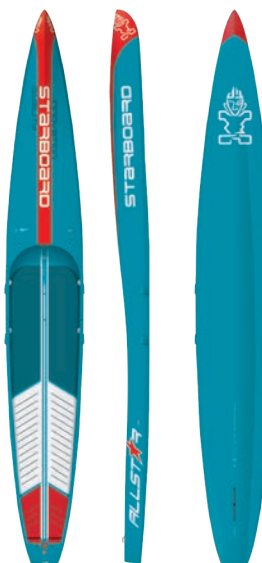

WOOD CARBON
(Best Value)
(only 28" 26" and 24.5" models)

IS THIS THE RIGHT BOARD FOR ME?

- The All Star is the world's most successful, user-friendly and versatile race design.
- NEW** • Dug out standing area lowers the center of gravity for increased stability and control, while the narrower tail accelerates faster and reaches higher top speeds.
- Board widths for all rider weights and skill levels. 24.5" and wider are suited for heavier riders, while 23.5 & 22.5" are for higher skilled and lighter riders.
- All Starboard team riders race and win on production boards from our own moulds.

AVAILABLE SIZES:

NEW 14'0" x 28"	NEW 14'0" x 26"	NEW 14'0" x 24.5"	NEW 14'0" x 23"	NEW 14'0" x 22.5"
12'6" x 28"	12'6" x 26"	12'6" x 24.5"	12'6" x 23.5"	12'6" x 23"

"It has got an incredible pick up of speed because of that V hull. It is, however, a lot more technical to use and you are going to have to be much more on it with your footwork, and transitioning to the back of the board for buoy turns and surfing are harder but if you do get the hang of it and understand how this V works on the bottom the board, it is going to be the fastest performing SUP racing board for you."

SUPBOARDERPRO

**2020 Test
WINNER**
STARBOARD ALL STAR

14' All Water Raceboard
**BEST PERFORMANCE
ALL WATER RACE**

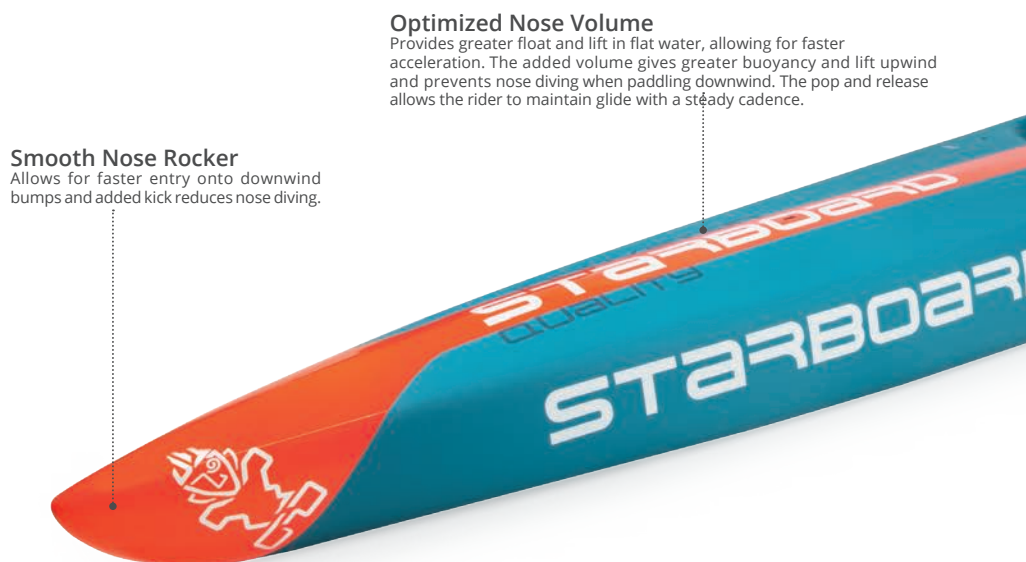

Smooth Nose Rocker

Allows for faster entry onto downwind bumps and added kick reduces nose diving.

Optimized Nose Volume

Provides greater float and lift in flat water, allowing for faster acceleration. The added volume gives greater buoyancy and lift upwind and prevents nose diving when paddling downwind. The pop and release allows the rider to maintain glide with a steady cadence.

Round Vee with Double Concave Bottom

- Sits higher on the water forcing the board to lift faster with every stroke. It feels lighter to paddle, allowing you to conserve more energy.
- During sprints, the board accelerates faster, as it lifts and glides on a narrower planing surface.
- Upwind it floats over chop easily without getting stuck, allowing you to keep a strong paddle cadence.
- Downwind it is faster and more responsive to maneuver.
- More forgiving in side chop, as it is less affected by the swell as it floats between the bumps.

Wide Chamfered Rail

Reduces the planing surface by nearly 20%, increasing the glide and overall speed.

Chamfered Rail Edge

Provides secondary stability to restrict the board from rolling.



Concave Side Planes

Provide stability, acting like stabilisers similar to a trimaran.

Boxy straight rails

Optimize the full outline of the board for greater stability and reduces rolling.

NEW

Extended and lower standing area

helps to lower the riders center of gravity for improved stability and control. Riders can now reach faster speeds and maintain speed over a longer time as they can focus on paddling with maximum power instead of losing energy balancing.

NEW

Efficient drainage

All 14'0" models now have 4 drainage holes to flush water out of the standing area as quickly as possible. The drain covers create suction to remove water inside and have a streamline water release when paddling.

9cm narrower tail outline

- Faster acceleration and overall glide per stroke due to less surface area & drag from the tail.
- Upwind the narrower tail helps the board flow naturally with bumps, helping to lift the nose over swell and glide into bumps creating a similar sensation to the Ace board.
- Downwind the narrower tail makes it more reactive to turn direction and maneuver between bumps.
- Easier to sink the lower volume tail to lift the nose for fast snappy buoy turning.

Multiple Handle Positions

Customise the handle placement for beach starts.



NEW

Scupper

Stick on drain covers can be purchased aftermarket to create suction to remove water inside and have a streamline water release when paddling.

Fin Tips

A longer center fin like the Race Ultra will provide greater stability and tracking in flat, while a smaller fin like the Natural Winner will deliver more downwind maneuverability.

NEW

Revised rocker lines

14'0"x22.5" now has a slightly flatter rocker for a more direct and longer lasting glide. The 14'0"x28" has a curved rocker to be more forgiving in downwind conditions.

Vee Tail

Makes it easier to steer the board when stepping back for smooth rail to rail transitions in surf and downwind.



Sprint

MEET OUR FASTEST BOARD

"The 2021 Sprint is my first choice for nearly every event. It's extremely fast without compromising on stability. Why would you paddle anything else?"
~ Michael Booth



CARBON SANDWICH
(Lightest Strongest)
(only 14'0" x 19.75" and 12'6" x 21.5")

WOOD CARBON
(Best Value)

IS THIS THE RIGHT BOARD FOR ME?

- Industry leader as the Fastest board for flat-water and small chop.
- The new 021 refinements are faster and more efficient, yet maintains the similar stability as the 020 models.
- All Starboard team riders race and win on production boards from our own moulds.

AVAILABLE SIZES:

NEW	NEW	NEW	NEW		
14'0" x 25"	14'0" x 23.5"	14'0" x 21.5"	14'0" x 19.75"	12'6" x 23"	12'6" x 21.5"

BE A SPEED MACHINE

The ultimate speedster for flat water and chop. Instant acceleration, amazing top-end speed.

Sloped Tail

The closed tail restricts water from flooding the tray when buoy turning and surfing, resulting in quicker acceleration and speed out of turns.

Beach Racing Handle Position

3 different handle positions for beach starts.

NEW

Dug Out Rails

Shaped for maximum stability, comfort and helps with balance in choppy conditions.

NEW

Efficient drainage & drain covers

4 drainage holes help flush water out of the standing area as quickly as possible. Stick on drain covers can be purchased aftermarket to create suction to remove water inside and have a streamline water release when paddling.

NEW

Straight and Raised rails

Reduces the board from rolling, limits water from entering the tray and allows the rider to stand lower in the water, giving added stability.

Rails are angled outwards so the widest point is at the top of the rail, and narrowest outline is at the bottom. The narrow planning surface reduces drag and increases overall speed. The wider outline at the deck still provides stability when leaning on the rail.

NEW

Thick slicing nose

Helps pop up faster in chop and cuts through the water on flats without diving and water wrapping over the nose.

NEW

Thicker Profile

Since the board is narrower, it sits lower in the water. The lost volume from the outline is redistributed onto the deck, making the shoulder rails higher for extra lift. Raised overall profile minimizes pitching with improved comfort and versatility to handle more challenging conditions.

NEW

The outline is straighter and narrower in the middle by 1".

- The narrower outline **accelerates faster** and maintains a **higher top speed** due to the reduced wetted surface area.
- The nose and tail outline remain the same width to **retain stability and pop**.
- Despite the narrower width, the size of the **inside standing tray** remains the same as 020 models.
- The result: a **faster glide** with the **stability of a wider board**.



NEW

Shallower center channel and more tail kick

Helps the board lift faster, increasing acceleration and overall top speed. The tail has slightly more tail kick, helping to lift the nose and manoeuvre in downwind bumps.

Race Ultra 2.0 fin

Supplied on all sizes for more direct tracking and stability.



PADDLE A DOWNWIND ACE

WHEN THERE'S CHOP, YOU NEED POP

The downwind game-changer for choppy water and open-ocean conditions.

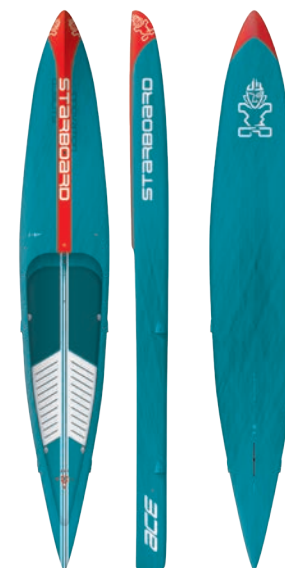

CARBON
(Full Carbon)

IS THIS THE RIGHT BOARD FOR ME?

- The Ace has been an original favourite since 2010, with its unique narrow tail outline and dug out standing area. With 10 years of development, the Ace has pioneered and led the innovation in dug out designs.
- The Ace is the fastest board for downwind specific races.
- 21.5" Ace is the fastest board for high skilled and lightweight riders up to 75kg.
- All Starboard team riders race and win on production boards from our own moulds.

AVAILABLE SIZES:

14'0" x 27"

14'0" x 24.5"

14'0" x 23"

NEW
14'0" x 21.5"

SUP DEDICATED TO FOIL



IS THIS THE RIGHT BOARD FOR ME?

- The combination of a short compact outline, distinct channelled bottom and thick profile make it the undeniable platform for those entry-level learning to foil up to the world's most progressive team riders.
- Recessed tray increases stability, while the EVA ridge helps to always be in position when up and foiling.
- NEW** • Nose outline, rocker line and rail shape all upgrade the foiling performance.



BLUE CARBON
(Lightest)



STARLITE
(Durable)



NEW
LITETECH
(Best-Value)

NEW 7'2" x 30"

BLUE CARBON / STARLITE /
LITETECH

Ultra-stable board that serves a dual purpose:

a winner for those learning the ropes of foiling and need a stable and wide platform, yet a high-performance and progressive board for heavier riders.

NEW 6'8" x 27.5"

BLUE CARBON / STARLITE /
LITETECH

Mid-size in the range, the new shorter 6'8" replaces the previous 7'2" making it easier to trim and more maneuverable without the nose catching through turns.

NEW 6'4" x 25"

BLUE CARBON / STARLITE /
LITETECH

The second smallest board in the range, the 6'4" feels arguably more stable than its predecessor due to the boxy rails widening the deck for maximum stability.

NEW 5'11" x 24"

BLUE CARBON / STARLITE /
LITETECH

Being the shortest and narrowest in the range, the new 5'11" is designed for higher skilled and lighter riders.

THE FUTURE IS FLIGHT

BREAK FREE AND FLY

THE HYPER NUT FOIL 4in1

is designed to offer:

- Windsurfing
- Windsurf Foiling
- SUP Surfing
- SUP Foiling

The 4in1 is heavier by approximately 300g than the Hyper Nut Foil only as it has more foot strap inserts and the mast track box. The Foil box on the 4in1 is positioned further back by on average 6.5cm to accommodate both Wind Foiling and SUP foiling.

THE HYPER NUT SURF AND FOIL

is the lightest option for those only wanting to SUP surf and SUP foil. The foil box is further forwards to generate more lift for downwind foiling and pump foiling. The Surf and Foil includes angled front straps and centred back strap for riders that prefer to ride in straps and always know where to position their feet.

THE HYPER FOIL

is designed as a dedicated SUP foil board only, as it does not have fins to use for surfing. It is the best performance option for those that want to SUP Foil only.

8'0" x 31.5"

FOIL 4in1: BLUE CARBON
SURF AND FOIL:
BLUE CARBON / STARLITE

Wider outline and longer length provides more stability for heavier riders and those learning the essentials of foil riding. The increased length makes it easier to get into waves.

7'4" x 30"

FOIL 4in1: BLUE CARBON
SURF AND FOIL:
BLUE CARBON / STARLITE

Combines short length for precise trim control of the foil with stability from the wide tail and width. Suited for lighter and more advanced riders.

FOIL BOX POSITION

Hypernut 4in1

8'0" x 31.5" - 51.5cm

7'4" x 30" - 47.5cm

Hypernut Surf and Foil

8'0" x 31.5" - 58.5cm

7'4" x 30" - 53.5cm

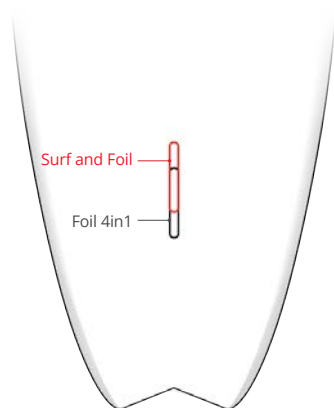

*Foil box is positioned from the tail to the middle of the box.

FOIL 4in1

IS THIS THE RIGHT BOARD FOR ME?

4 sports in 1 board, makes it the most versatile board we have ever made.

- SUP Surf
- SUP Foil
- Windsurf
- Windsurf Foil



STARLITE
(Durable)



BLUE CARBON
(Lightest)



STARLITE
(Durable)

FOOT STRAP POSITION:

1. Wind foiling



2. Wavesailing



Surf foiling



SURF and FOIL

- 2in1 board, the lightest option for SUP foiling and SUP surfing.
- Foil box is positioned for downwind and surfing.

FLIGHT MODE UNLOCKED

ULTRA-LIGHT WEIGHT



FLAT ROCKER = INCREASED PADDLE SPEED
NARROWER NOSE = SMOOTHER TOUCH DOWNS
CONCAVE DECK = INCREASED STABILITY

The second-generation Foil Surf range is the result of extensive testing and development between designer Clinton Filen and athletes Zane Schweitzer and Benoit Carpentier.



BLUE CARBON
(Lightest)

The sizes are designed to be as short as possible for greatest manoeuvrability, speed and control, while also being stable and fast to paddle into waves.

NEW 5'6" x 21.5"
BLUE CARBON

The longest and highest volume model, offering the fastest and easiest glide getting into waves for riders up to 95kg.

NEW 5'2" x 20.5"
BLUE CARBON

A great versatile board for most rider weights, offering a great progression for beginners to intermediate riders up to 90kg.

NEW 4'8" x 19.25"
BLUE CARBON

Ideal for heavier riders up to 80kg that are intermediate riders.

NEW 4'3" x 18.5"
BLUE CARBON

The lowest volume designed for lightweight and advanced riders up to 70kg, - Zane Schweitzer's board of choice.

NEW 5'11" x 24" HYPER FOIL
BLUE CARBON, LITETECH

Acts as a 2 in 1, being the shortest SUP Foil board and also a stable prone foil surf option.

THE BETTER GENERATION

SMALL BOARDS FOR SMALL RIPPERS

IS THIS THE RIGHT BOARD FOR ME?

The SUPKids line is ready to get every grom on the water. Based on award winning designs, the SUPKids range offers scaled down shapes for kids to learn the sport of SUP racing and SUP surfing.



INFLATABLE



SUPKIDS RACER
DELUXE
SINGLE CHAMBER



SUPKIDS
ZEN
SINGLE CHAMBER

10'6" x 23"
DSC

Straight narrow outline increases the glide and tracking as kids can hold the paddle closer and straighter to the board.

9'0" x 28"
ZSC

Scaled width down to 28" to be able to keep the paddle more straight and good glide with combo of narrow mid section and 9' length.

HARD BOARD



SUPKIDS ALLSTAR
WOOD CARBON



SUPKIDS PRO
ASAP

10'6" x 22"
WOOD CARBON

A perfect board for future racers in all-rounder racing conditions.

7'4" x 25.5"
ASAP

Based on World Champion Sean Poynter's pro model, the 7'4" is short and nimble for kids to turn in waves, yet stable to float riders up to 50kg.

SUP WINDSURFING IT'S TIME TO HOLD THE WIND IN YOUR ARM



Rocio Tarodo, Bart De Zwart | Chedtha Nuilek | Rayong, Thailand

IS THIS THE RIGHT BOARD FOR ME?

The SUP Windsurfing range offers a great choice for sharing windsurfing and paddle boarding with friends and family. They glide with ease, very different from anything we have offered in the past. Starboard brought home 11 out of 12 PWA constructor titles over the last 12 years and we love getting more people into windpowered fun.

INFLATABLE



INFLATABLE
DELUXE
SINGLE CHAMBER



INFLATABLE
ZEN
SINGLE CHAMBER

NEW 11'2" x 31" iGO

DSC WS / ZSC WS

A fast outline where the + stands for the square tail/ nose shape and the added ¼ width which altogether creates additional stability.

NEW 10'8" x 33" iGO

DSC WS

A popular entry-level size, perfect for schools and centres that want 1 board that does it all.

NEW 12'6" x 30" TOURING

DSC WS

Our faster SUP Windsurfing board, suited for riders up to 110kg. The 12'6" combines a balance of speed, stability and maneuverability.

HARD BOARD



HARD BOARD
STARLITE



HARD BOARD
ASAP

12'0" x 34" GO

STARLITE WS / ASAP WS

Delivers performance with ease, the most stable shape in the range.

12'0" x 30" GO

STARLITE WS / ASAP WS

The fastest GO board, offering surprising glide and stability in a traditional surf outline shape.

11'2" x 32" GO

STARLITE WS / ASAP WS

A truly amazing board, our best selling Go board. Glide and stability due to the concave hull and boxy rails.

Our wind-friendly SUP shape has added nose kick for more lift over chop when windsurfing.

Quicker turning and easier to move around. A fast, nimble and effortless glide.

10'8" x 31" GO

STARLITE WS

10'0" x 34" WHOPPER

ASAP WS

A highly popular, stable board which surprises with incredible wave riding ability.

FREEWING

ONE STEP AHEAD OF EVERYTHING

FREEWING AIR

FREEWING

SIZE: 2, 3, 4, 5, 6, 7, 8

Innovation levels rise fast in our new sport.

This is an all-around wing that's easy to use. It's especially controllable when overpowered and efficient when pumping in light wind due to the generous strut diameter which solidifies the frame's stiffness. The wing is surprisingly stable when luffed in the neutral position, making it ideal for downwinders and carving. The inward-angled wing tips keeps the wing out of the water when getting started and when overpowered. Light weight localized strut reinforcements for added durability.

We focused on reduced arm pressure and extra comfort when riding for long periods of time. Every size has been precisely designed to achieve maximum control and performance. Optimal for wingfoil beginners to down-the-line wave riders. High-visibility windows allows safety in crowds – the more you see, the safer you'll be!

TOP FEATURES & HIGHLIGHTS

- ▶ Extra large strut diameter for stability, control and speed.
- ▶ The inward angled wing tips on the 5, 6, 7 and 8 m² sizes to keep the tips out of the water when starting or overpowered.
- ▶ Lightweight and easy to uphaul.
- ▶ Very powerful, with arm pressure minimized due to easy de-power.
- ▶ Extended windows for a much larger field of vision.

OTHER IMPORTANT FEATURES

- ▶ Harness lines reduce fatigue in the arms, allowing you to ride for longer periods.
- ▶ Included leash with cuff system, allowing one handed strap in.
- ▶ Angled handles for convenience getting started and to perform jibes and maneuvers.
- ▶ Thicker, softer, wide handles for micro-trimming at speed.



NOZZLE ADAPTER **NEW**

Allows you to turn the SUP Tiki Pump and V8 Pump into FreeWing pump.

*Provided with every FreeWing from July shipment onwards

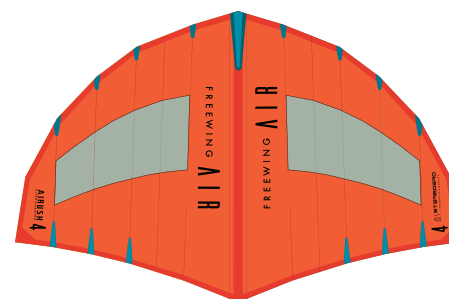

ORANGE / RED

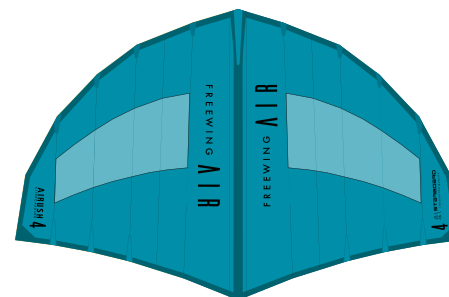

TEAL / TEAL

INFLATABLE WINGBOARDS



WINGBOARD
DELUXE
SINGLE CHAMBER

WINGBOARD
4in1
DELUXE
SINGLE CHAMBER

NEW 5'8" x 27" WINGBOARD
DSC

This is the smallest board in the inflatable range. Designed for the most skilled and/or the lightest riders looking for high maneuverability while wing foiling.

NEW 6'8" x 29" WINGBOARD
DSC

In the middle of the range, this board is perfect for people learning to wing foil, as well as for those who prefer a good balance of stability, maneuverability and glide. Recommended for rider up to 95kg.

NEW 7'0" x 31" WINGBOARD
DSC

The biggest board in our range provides the most stability and float for riders up to 105kg. The gained glide from the length allows the riders to accelerate and get flying quicker.

NEW 10'4" x 32" WINGBOARD 4in1
DSC

Ideal for those who want to learn to handle a FreeWing in the water without the use of a foil. The wide nose and tail provide enough stability, while the length and parallel rails generate the glide and speed. The removable center fin helps going upwind and the foot straps indicate the best standing position to start learning. The board comes with a removable mast base for windsurfing, rail edges for better release and a carry strap that can also be used as a paddle holder. On top of being a Wing - SUP- and Windsurfing board, the 10'4" can be paddled with the wing if the wind drops and the rider is caught in the middle of a session.

HARD WINGBOARDS



WINGBOARD
BLUE CARBON

WINGBOARD
LITE TECH

WINGBOARD
4in1
ASAP

WINGBOARD
4in1
LITE TECH

NEW 7'0" x 30" WINGBOARD
BLUE CARBON / LITE TECH

Is the most stable size for heavier riders up to 110kg and those wanting extra stability. The longer length increases the glide and speed to get flying.

NEW 6'7" x 28" WINGBOARD
BLUE CARBON / LITE TECH

Is the mid-size, an ideal balance between stability, glide and manoeuvrability for riders up to 95kg.

NEW 5'8" x 25" WINGBOARD
BLUE CARBON / LITE TECH

Short length and narrow width at 25" is a performance size for intermediate to advanced riders up to 85kg.

NEW 4'6" x 25" WINGBOARD
BLUE CARBON / LITE TECH

Is smallest size and most manoeuvrable model for advanced and lightweight riders up to 75kg.

NEW 10'4" x 32" WINGBOARD 4in1
ASAP / LITE TECH

The state of the art learning tool for Wingboarding. The length provides the glide and ability to stay upwind. The thick rails, concave bottom and overall volume makes it super stable. Footstrap inserts are placed perfectly for the first Wing classes, helping to find the right foot positioning. This board is designed and tested for Wingboarding, and is at the same time a fabulous 10'4" x 32" GO paddle board. As a Windsurfing board it's easy to learn on and you will enjoy an amazing glide in lighter winds.

WING BOARDING IS HAPPENING.

And performance levels are rising

Some riders “get it” right away, while others struggle, this is much down to choosing the right gear and understanding the basics technical aspects.

Our target is early and easy take off, superb balance while riding, easy touch down with fast relaunch.

To get started we need stability and since volume works on leverage, the further away the volume is from your feet, the more stability it creates. We placed the volume in the rails, at the square nose and at the little “platform” at the tail of the board. Stability is also created by having the feet as close to the foil as possible. We do not want to foil with “High Heels”, so the thinner a board is, the better it rides.



Recessed deck
improves stability and control, while the drain area aft lets the water out immediately

The flat tail rocker
and sharp rails forward increase ground speed until take off.



Sharp channel
that get deeper towards the tail help pump, rock the board into release and also helps for stability.

FreeWing

FreeWing share the stoke of Kite, SUP and Windsurf into a single flying experience.

Working with the design team from both Airush and Starboard, FreeWings fuse the innovation and ideology of the different sports into groundbreaking designs with refined performance.

With development between Thailand, Bali, Tarifa, Cape Town and Maui, we have been able to optimize both light wind and high wind performance to suit your local conditions.

<https://freewing.star-board.com/>



Alejo Oribea



Samuel Cardenas

AIRUSH
KITEBOARDING



STARBOARD
INNOVATION QUALITY